

PROPOSED GUARDRAIL CURVE DATA				
Curve #	Radius	Length	Tangent	Delta
GR1	8.25'	5.93'	3.10'	41°11'49"
GR2	5.62'	16.71'	66.30'	170°18'33"
GR3	5.00'	2.79'	1.43'	31°59'05"

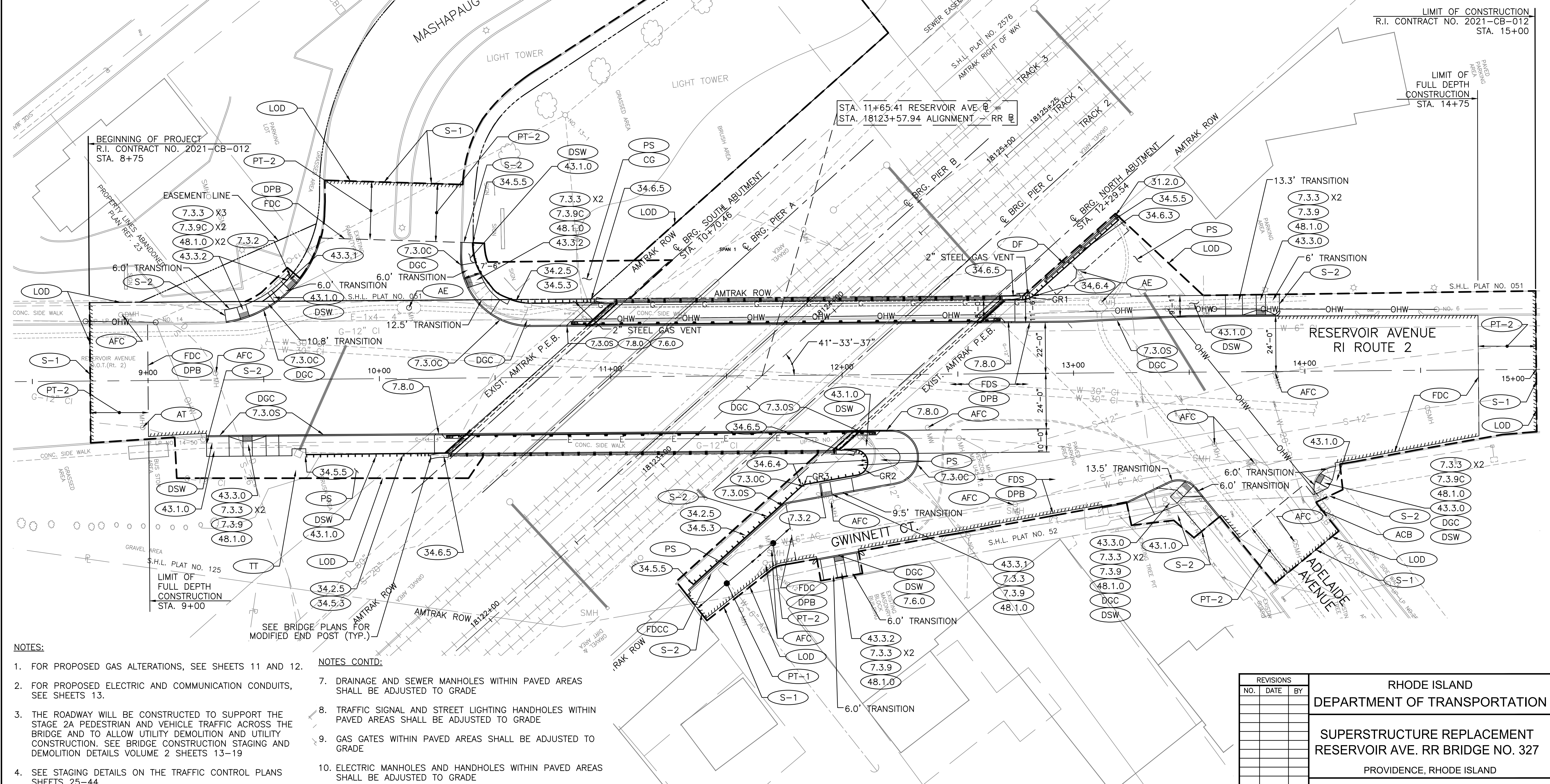

- NOTES:**
- FOR PROPOSED GAS ALTERATIONS, SEE SHEETS 11 AND 12.
  - FOR PROPOSED ELECTRIC AND COMMUNICATION CONDUITS, SEE SHEETS 13.
  - THE ROADWAY WILL BE CONSTRUCTED TO SUPPORT THE STAGE 2A PEDESTRIAN AND VEHICLE TRAFFIC ACROSS THE BRIDGE AND TO ALLOW UTILITY DEMOLITION AND UTILITY CONSTRUCTION. SEE BRIDGE CONSTRUCTION STAGING AND DEMOLITION DETAILS VOLUME 2 SHEETS 13-19
  - SEE STAGING DETAILS ON THE TRAFFIC CONTROL PLANS SHEETS 25-44
  - MAINTAIN PEDESTRIAN ACCESS TO SIDEWALKS AT ALL TIMES DURING CONSTRUCTION
  - MAINTAIN VEHICULAR ACCESS TO DRIVEWAYS AT ALL TIMES DURING CONSTRUCTION

- NOTES CONTD:**
- DRAINAGE AND SEWER MANHOLES WITHIN PAVED AREAS SHALL BE ADJUSTED TO GRADE
  - TRAFFIC SIGNAL AND STREET LIGHTING HANDHOLES WITHIN PAVED AREAS SHALL BE ADJUSTED TO GRADE
  - GAS GATES WITHIN PAVED AREAS SHALL BE ADJUSTED TO GRADE
  - ELECTRIC MANHOLES AND HANDHOLES WITHIN PAVED AREAS SHALL BE ADJUSTED TO GRADE
  - COMMUNICATION MANHOLES AND HANDHOLES WITHIN PAVED AREAS SHALL BE ADJUSTED TO GRADE
  - WATER GATES WITHIN PAVED AREAS SHALL BE ADJUSTED TO GRADE

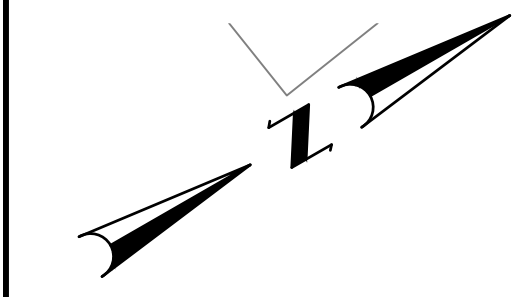
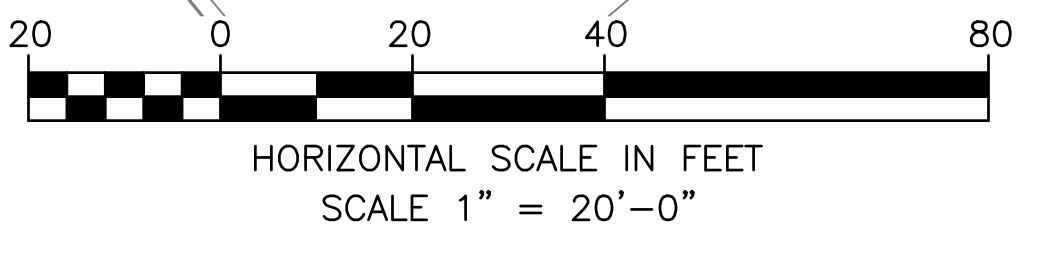

**Louis Berger**  
 166 VALLEY STREET, BUILDING 5  
 PROVIDENCE, RI 02909  
 TEL 401 521 5980  
 WWW.LOUIISBERGER.COM

REVISIONS		
NO.	DATE	BY

RHODE ISLAND  
DEPARTMENT OF TRANSPORTATION

SUPERSTRUCTURE REPLACEMENT  
RESERVOIR AVE. RR BRIDGE NO. 327  
PROVIDENCE, RHODE ISLAND

**GENERAL PLAN**

CHECKED BY PWS DATE 11/23/2020 SCALE AS NOTED