

FED. ROAD DIV. NO.	STATE	FEDERAL AID PROJECT NO.	FISCAL YEAR	SHEET NO.	TOTAL SHEETS
	RI	BRO-0327(005)	2021	48	52

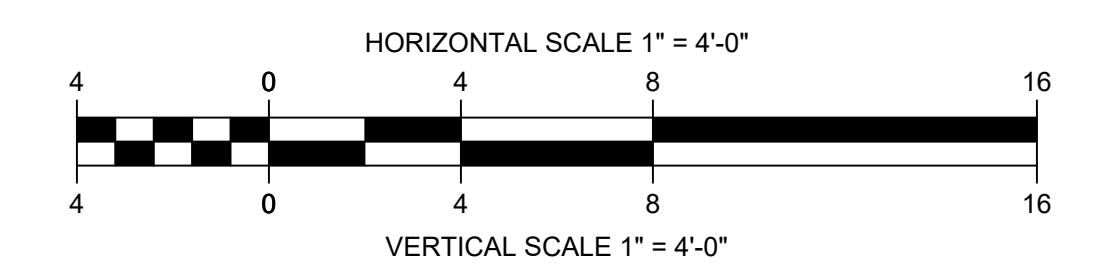
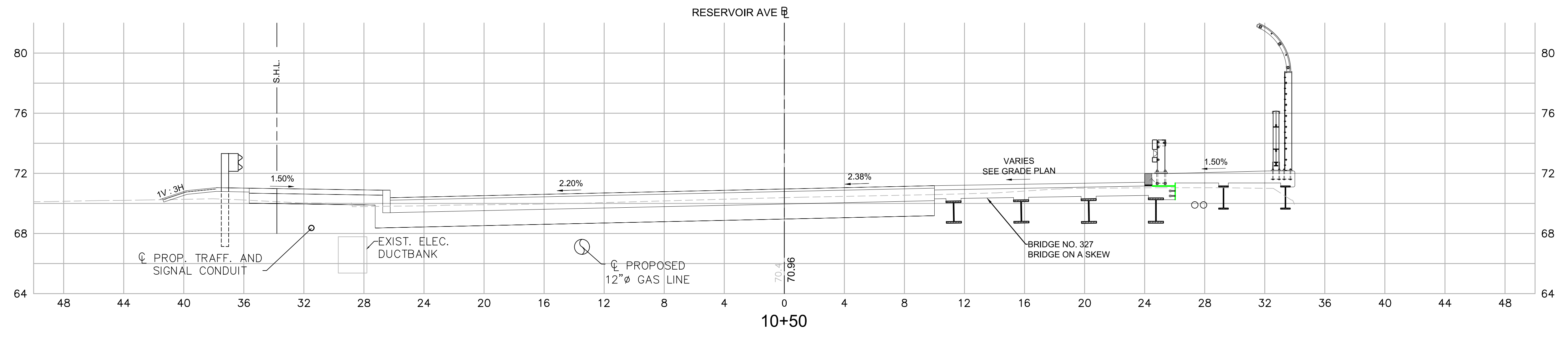
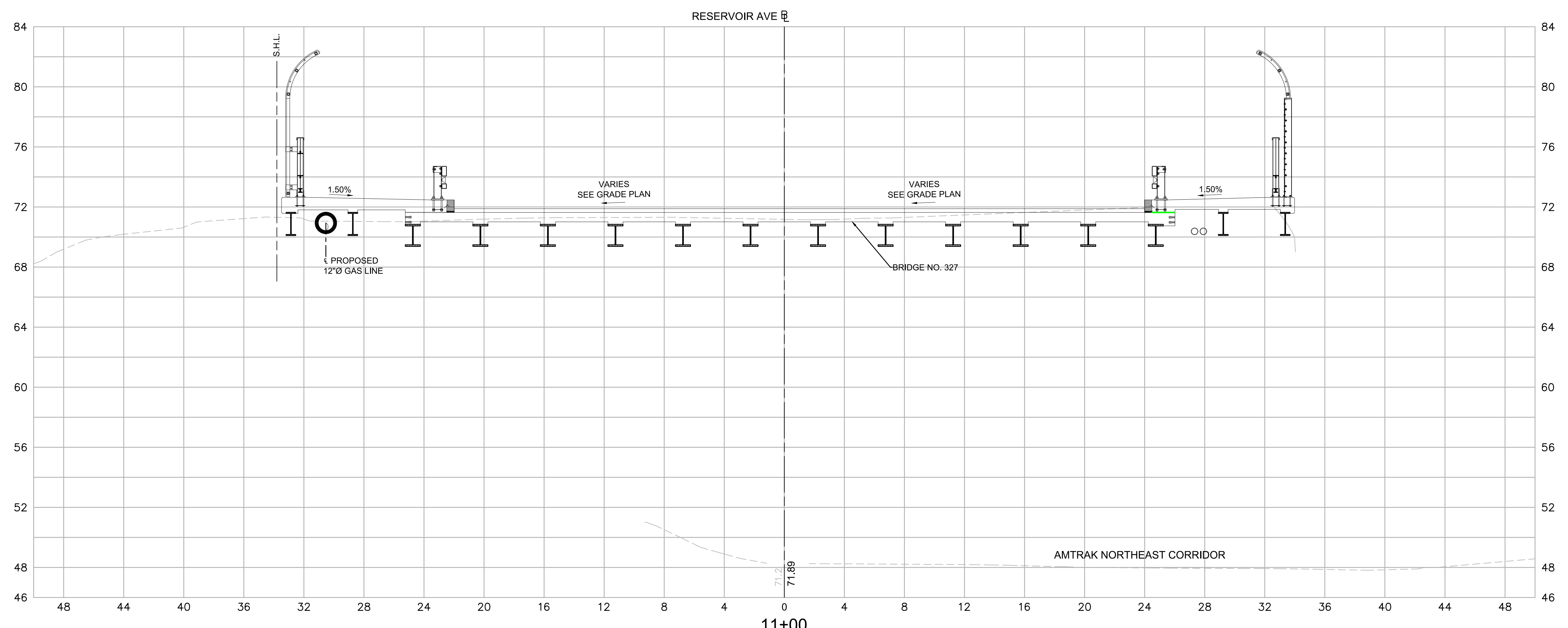

Louis Berger
 166 VALLEY STREET, BUILDING 5
 PROVIDENCE, RI 02909
 TEL 401 521 5980
 WWW.LOUISBERGER.COM

REVISIONS		
NO.	DATE	BY

**RHODE ISLAND
DEPARTMENT OF TRANSPORTATION**

**SUPERSTRUCTURE REPLACEMENT
RESERVOIR AVE. RR BRIDGE NO. 327
PROVIDENCE, RHODE ISLAND**

CROSS SECTIONS 2

CHECKED BY PWS DATE 11/23/2020 SCALE AS NOTED