

DATE	TIME	TEMPERATURE	WIND	WEATHER
7/25/67	8:00	82.0	SW 10	CLD
7/25/67	9:00	81.0	SW 10	CLD
7/25/67	10:00	80.0	SW 10	CLD
7/25/67	11:00	79.0	SW 10	CLD
7/25/67	12:00	78.0	SW 10	CLD
7/25/67	13:00	77.0	SW 10	CLD
7/25/67	14:00	76.0	SW 10	CLD
7/25/67	15:00	75.0	SW 10	CLD
7/25/67	16:00	74.0	SW 10	CLD
7/25/67	17:00	73.0	SW 10	CLD
7/25/67	18:00	72.0	SW 10	CLD
7/25/67	19:00	71.0	SW 10	CLD
7/25/67	20:00	70.0	SW 10	CLD
7/25/67	21:00	69.0	SW 10	CLD
7/25/67	22:00	68.0	SW 10	CLD
7/25/67	23:00	67.0	SW 10	CLD
7/25/67	24:00	66.0	SW 10	CLD

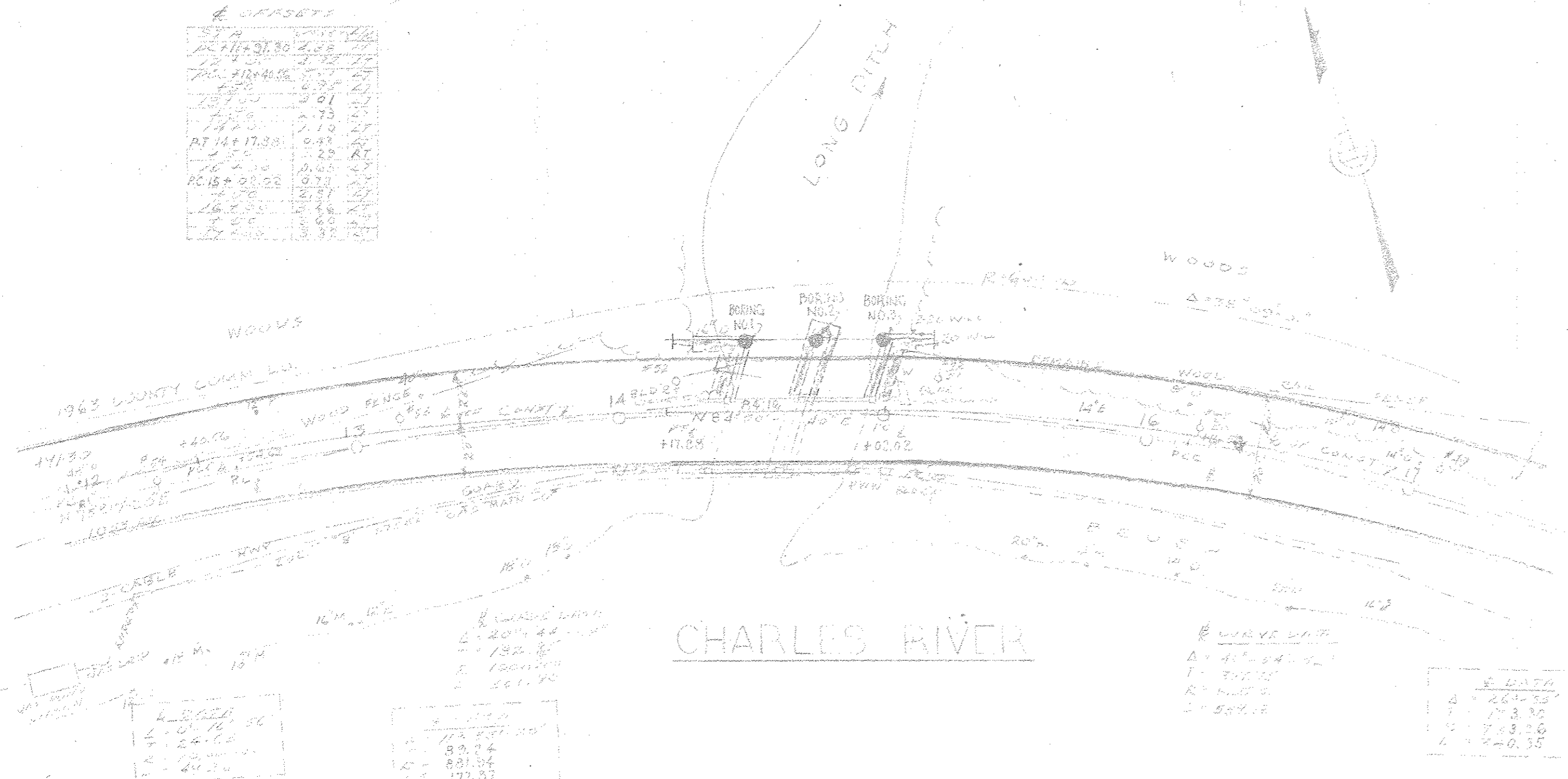

KEY PLAN  
SCALE 1"=40'

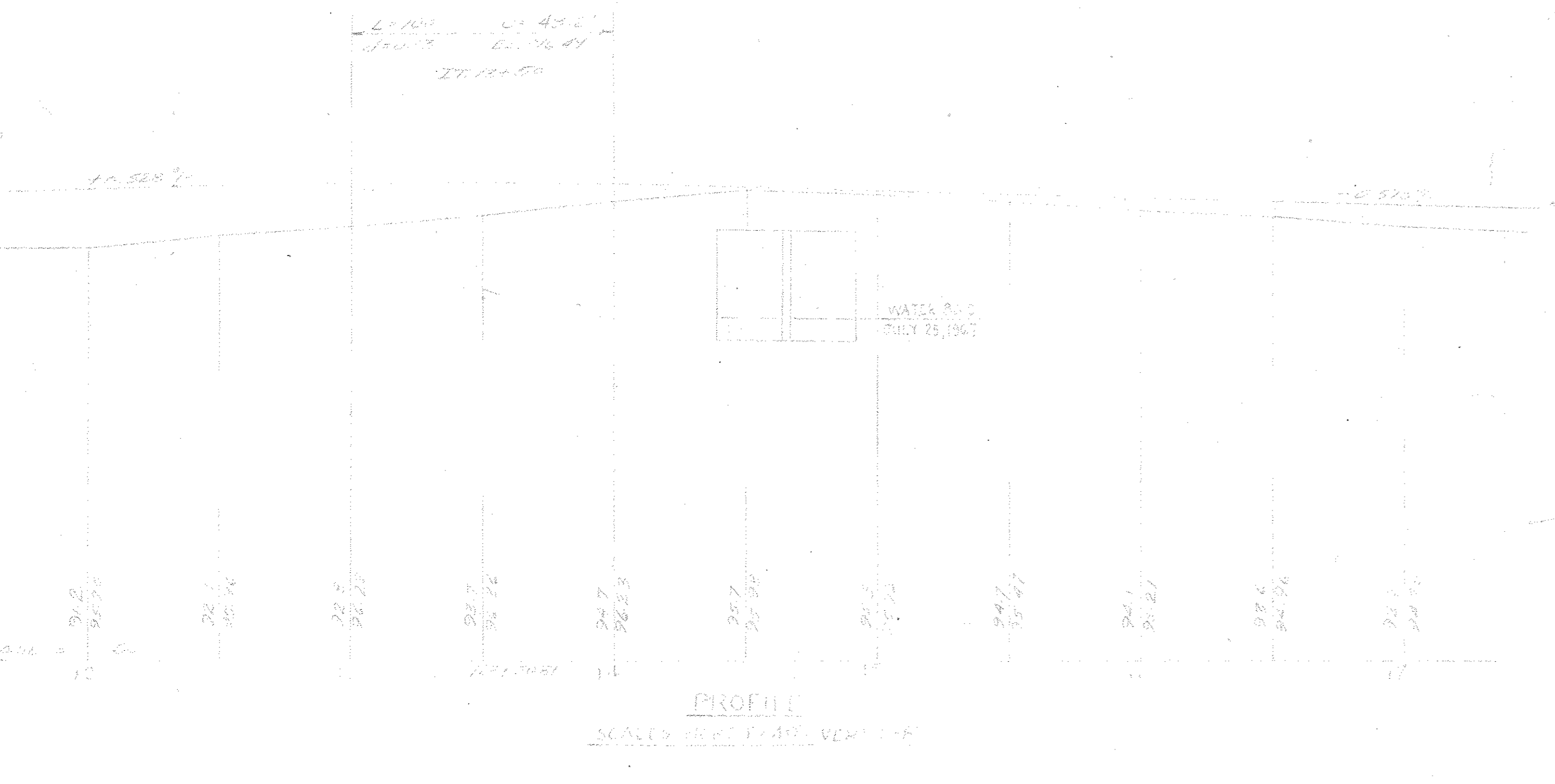

PROFILE  
SCALE: HORIZ. 1"=40' VERT. 1"=5'

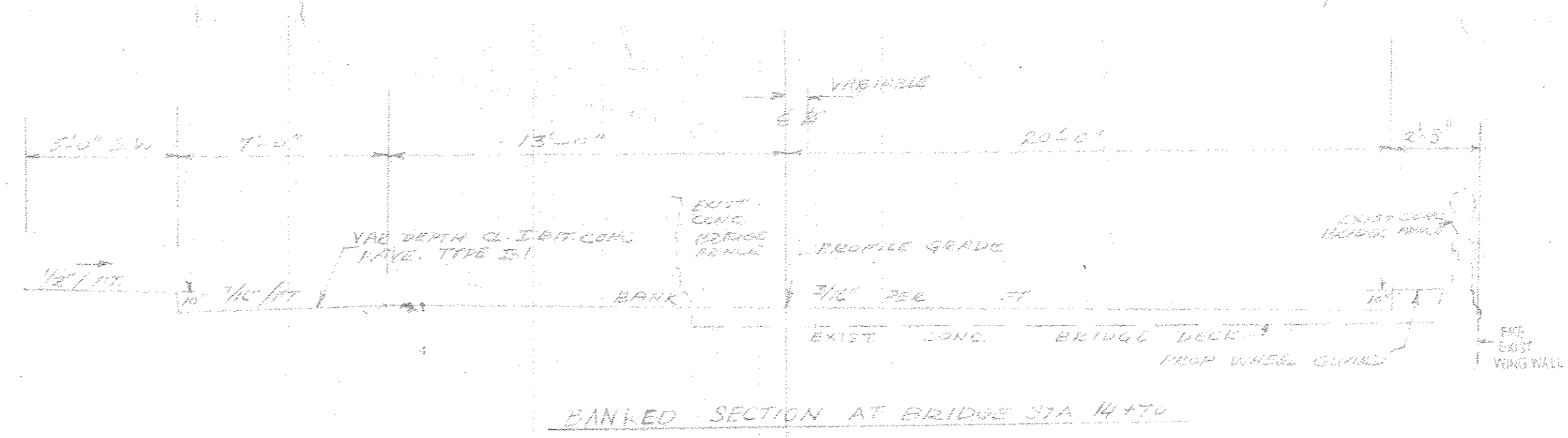

BRIDGED SECTION AT BRIDGE STA 14+70

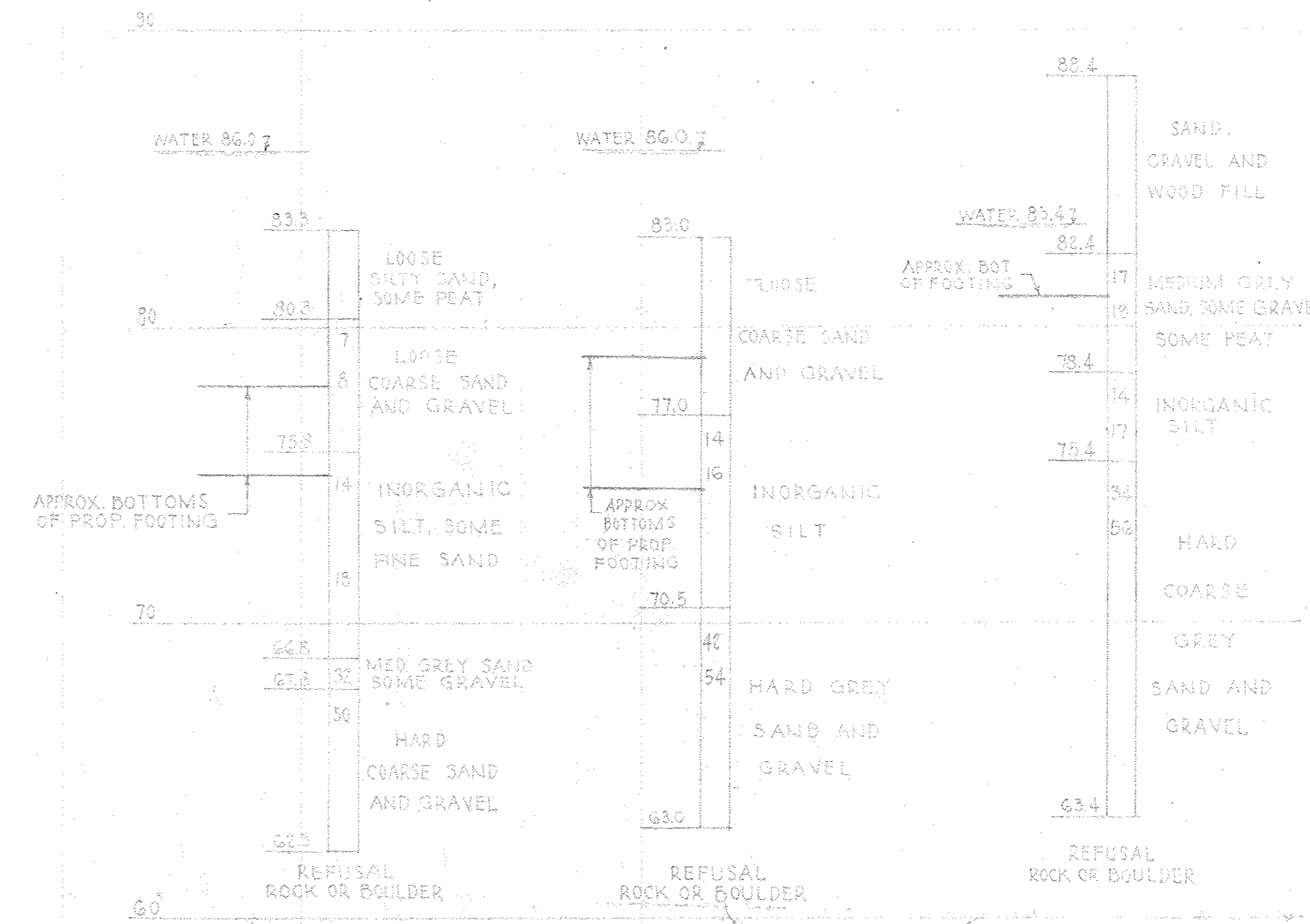

BORING DATA  
SCALE 1"=4'

BORINGS TAKEN BY MASS. DEPT. OF PUBLIC WORKS RESEARCH & MATERIALS SECTION JULY 1967

GENERAL NOTES	
FEDERAL AID PROJECT NO. CMAA 50	
TYPE OF PROJECT: BRIDGE DESIGN LOADING: HS20-44 APPROXIMATE 15 A.M. 1967	
MEAN SEA LEVEL 1929 DATUM - U.S.C. & G.S.	
PLAN NOS.	
PROFILE NOS.	
NOTE BOOKS	
CROSS-SECTIONS	
TRAFFIC DATA	
DESIGN YEAR	MAINLINE LOCAL RD.
AVERAGE DAILY TRAFFIC-PRESENT	
AVERAGE DAILY TRAFFIC-DESIGN YEAR	
DESIGN HOUR VOLUME	
DIRECTIONAL DISTRIBUTION	
TRUCK PERCENTAGE	AVERAGE DAY PEAK HOUR
DESIGN SPEED	
DIRECTIONAL DESIGN HOUR VOLUME	

BM. STA. 12190 RT. 64.5' VERTICAL SPIKE IN ROOT OF 16" MAPLE EL. 90.55 SEA LEVEL DATUM OF 1929.

REVISED 3/25/67. EXIST. SUPERSTRUCTURE REPAIRED AND BEAMS RESPAVED  
REVISED 7/16/67. CROSS SECTION CHANGES

THE COMMONWEALTH OF MASSACHUSETTS  
DEPARTMENT OF PUBLIC WORKS

SKETCH PLAN  
PROPOSED BRIDGE WIDENING  
DEDHAM  
NEEDHAM STREET OVER  
LONG DITCH

SCALE: AS NOTED DATE: 15th AUGUST 1967

APPROVED BY: [Signature] DATE: 7/26/67  
HIGHWAY DESIGN ENGINEER: [Signature] DATE: 7/26/67  
INSURANCE & STRUCTURES ENGINEER: [Signature] DATE: 7/26/67

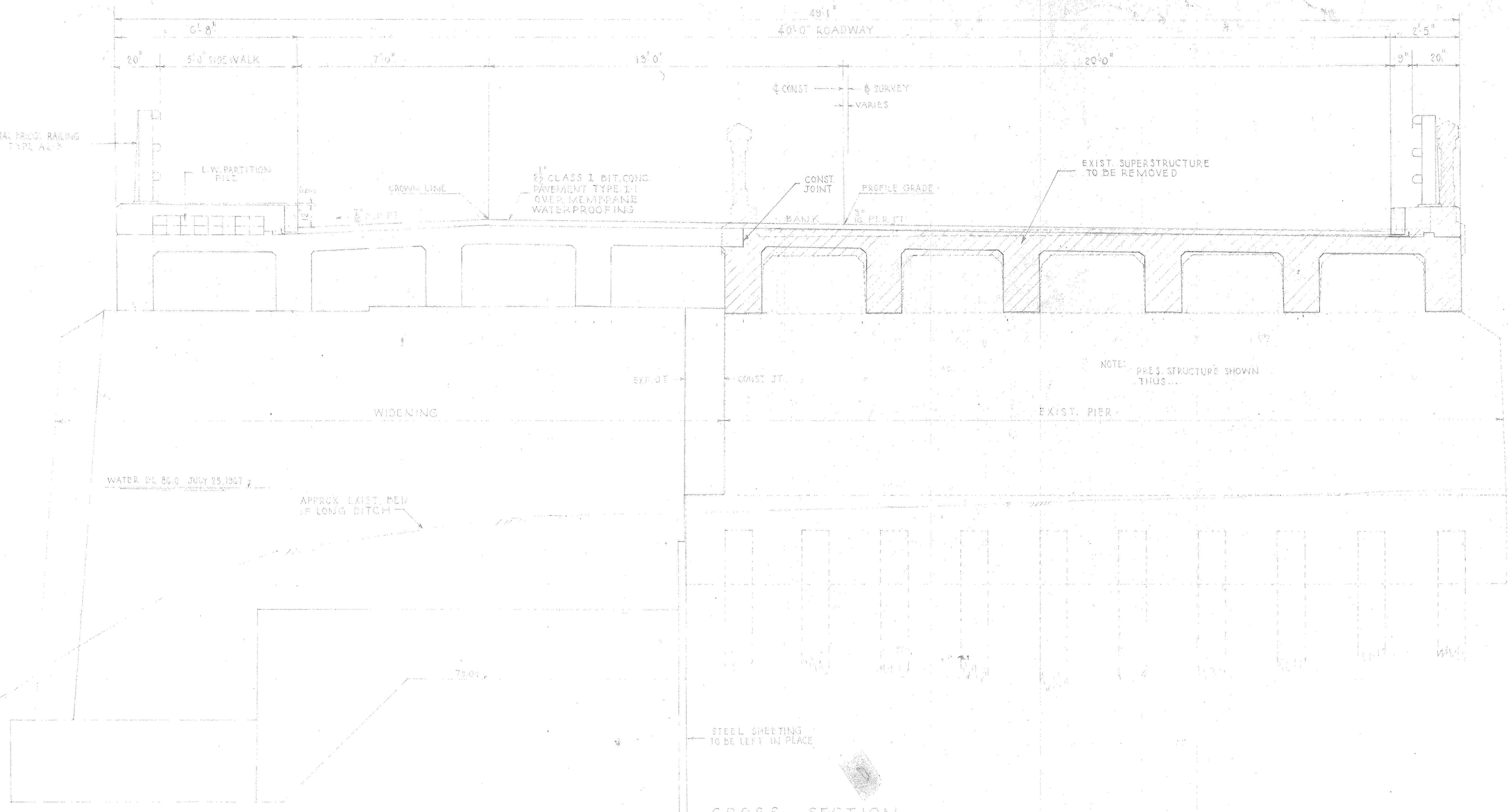

CROSS SECTION  
 SCALE 1/2" = 1'-0"  
 SHOWING PIER EXTENSION

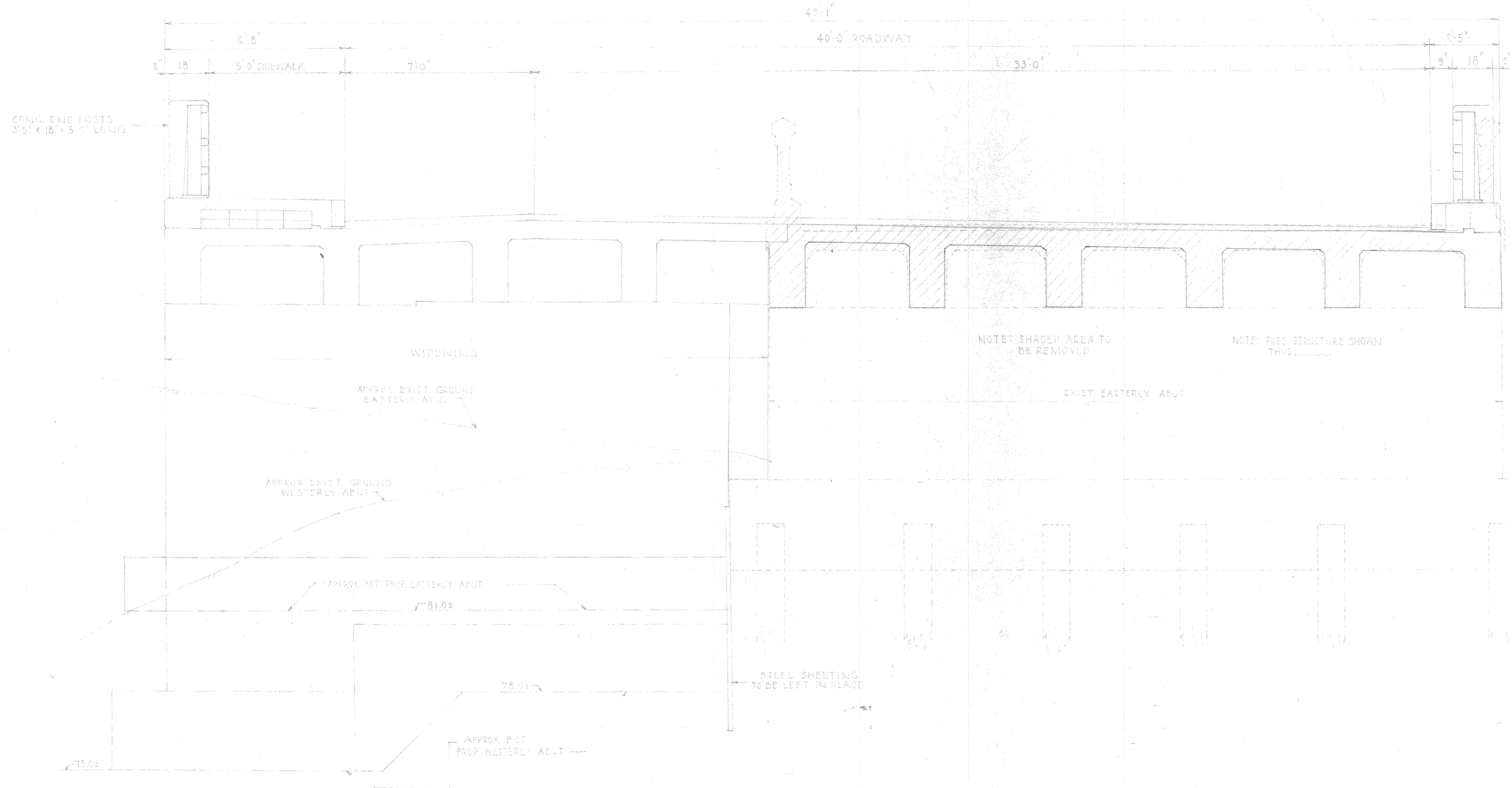

CROSS SECTION  
SCALE 1/2" = 1'-0"  
SHOWING EASTERLY ABUTMENT

DEDHAM - Needham St. Bridge  
11d

