

ENVIRONMENTAL PERMIT PLANS

STATE PROJECT NO. 0017-0192

REPLACEMENT OF BRIDGE NO. 04487

EAST STREET OVER PEQUABUCK RIVER

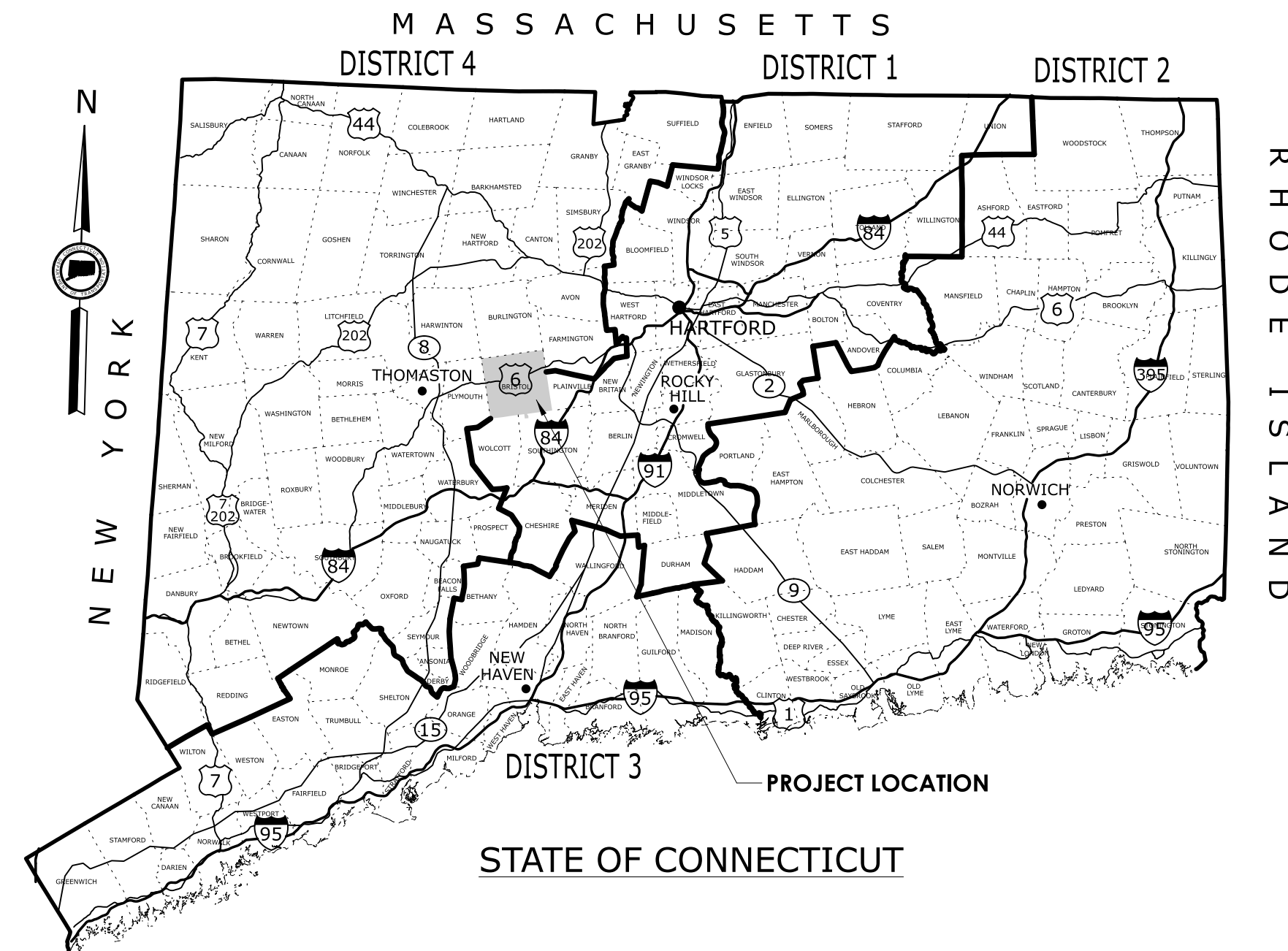

Town(s)/City of
BRISTOL, CT

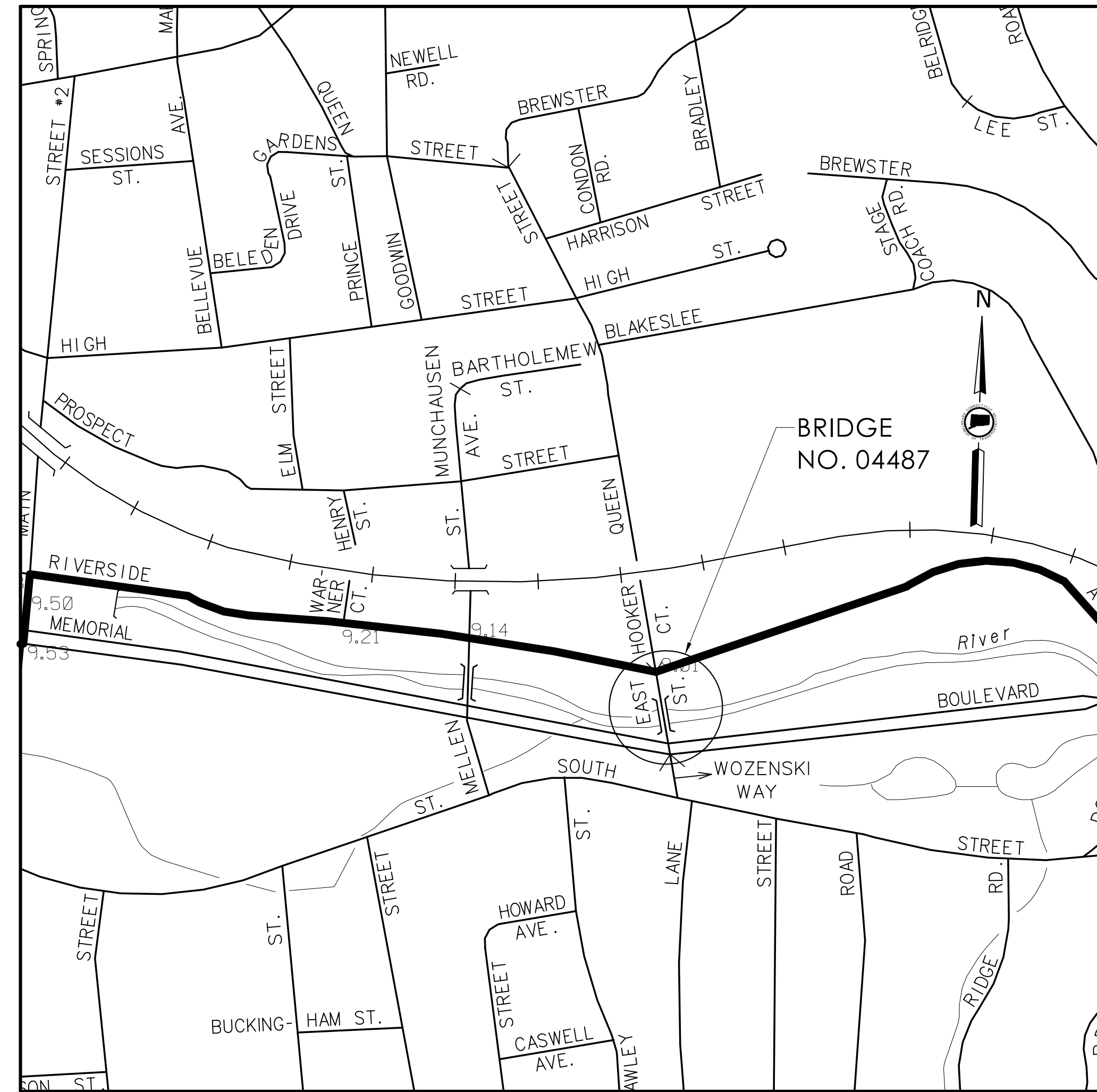

LOCATION PLAN
NOT TO SCALE

GENERAL NOTES:

1. FEDERAL AID PROJECT NO.
2. THESE PLANS ARE NOT INTENDED FOR CONSTRUCTION AND ARE INTENDED ONLY FOR ENVIRONMENTAL PERMITTING PURPOSES THESE PLANS HOLD AUTHORITY FOR ALL ACTIVITIES CONCERNING THE REGULATED AREA. FOR DETAILED PLANIMETRIC INFORMATION AND PAYMENT, REFER TO THE APPLICABLE CONTRACT DOCUMENTS.
3. FOR A DESCRIPTION OF THE WATERCOURSES, WETLANDS, AND WETLAND SOILS, SEE RELEVANT SECTIONS OF THE PERMIT APPLICATION.
4. 400 FOOT GRID BASED ON CONNECTICUT COORDINATE SYSTEM N.A.D. 1983 VERTICAL DATUM BASED ON NAVD 2020
5. ALL CONSTRUCTION ACTIVITIES WILL BE CONDUCTED IN ACCORDANCE WITH THE DEPARTMENT'S STANDARD SPECIFICATIONS FOR ROADS, BRIDGE, FACILITIES AND INCIDENTAL CONSTRUCTION, FORM 818, DATED 2020, SECTION 1.10, AND SUPPLEMENTAL SPECIFICATIONS, DATED JULY 2022, AND WILL ALSO FOLLOW REQUIRED BEST MANAGEMENT PRACTICES (BMPs) AND SEDIMENT AND EROSION CONTROL MEASURES IN ACCORDANCE WITH THE 2002 EROSION & SEDIMENTATION CONTROL GUIDELINES AND THE 2004 STORMWATER QUALITY MANUAL.

Bruce H Williams
DEEP Fisheries Division - 03/23/23

LIST OF DRAWINGS

SHEET NO.	DRAWING TITLE
PMT-01	TITLE SHEET
PMT-02	GENERAL SITE PLAN
PMT-03	WETLAND IMPACT PLAN
PMT-04	100-YEAR FLOODPLAIN IMPACT PLAN
PMT-05	GENERAL BRIDGE PLAN
PMT-06	WATER HANDLING PLAN

ENVIRONMENTAL PERMIT PLANS - 02/03/2023

REV.	DATE	REVISION DESCRIPTION

FINAL DESIGN REVIEW

NOT TO SCALE

SIGNATURE/
BLOCK:



CITY OF BRISTOL

PROJECT NUMBER: 0017-0192
PROJECT DESCRIPTION: REPLACEMENT OF BRIDGE NO. 04487, EAST STREET OVER PEQUABUCK RIVER
TOWN(S): BRISTOL
DRAWING TITLE: TITLE SHEET

DRAWING NO.
PMT-01
SHEET NO.

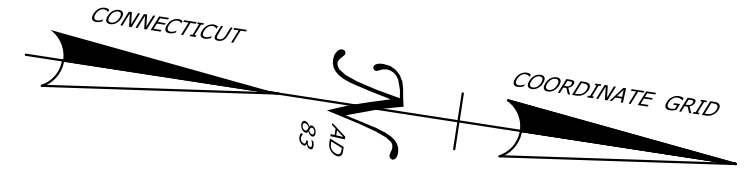

**BEGIN PROJECT NO. 0017-0192
LIMIT OF FULL DEPTH RECONSTRUCTION
BL STATION 10+89.30
MATCH EXISTING PAVEMENT**

**END PROJECT NO. 0017-0192
LIMIT OF FULL DEPTH RECONSTRUCTION
BL STATION 13+20.00
MATCH EXISTING PAVEMENT**

- LEGEND**
- 100YR — FEMA 100-YR FLOOD (CALCULATED)
 - SEDIMENTATION CONTROL SYSTEM
 - FLOODWAY
 - OHW — ORDINARY HIGH WATER LINE
 - STATE WETLANDS
 - PROPOSED FILL LINE
 - PROPOSED CUT LINE

- ROW LEGEND**
- (A) PARTIAL TAKE REQUIRED
 - (B) CONSTRUCTION EASEMENT REQUIRED
 - (C) RIGHT TO GRADE REQUIRED
 - (D) RIGHT TO INSTALL SEDIMENTATION CONTROL SYSTEM REQUIRED

REV.	DATE	REVISION DESCRIPTION

DESIGNER/DRAFTER: NAB
CHECKED BY: PMB

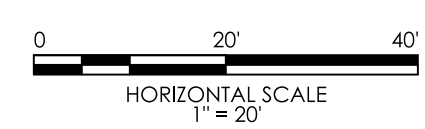

SIGNATURE/BLOCK: **GMP**
GMP ASSOCIATES, INC.
115 GLASTONBURY BLVD.
GLASTONBURY, CT 06033



CITY OF BRISTOL

PROJECT NUMBER: 0017-0192
PROJECT DESCRIPTION: REPLACEMENT OF BRIDGE NO. 04487, EAST STREET OVER PEQUABUCK RIVER
TOWN(S): BRISTOL
DRAWING TITLE: GENERAL SITE PLAN

ENVIRONMENTAL PERMIT PLANS - 02/03/2023

DRAWING NO. PMT-02
SHEET NO.

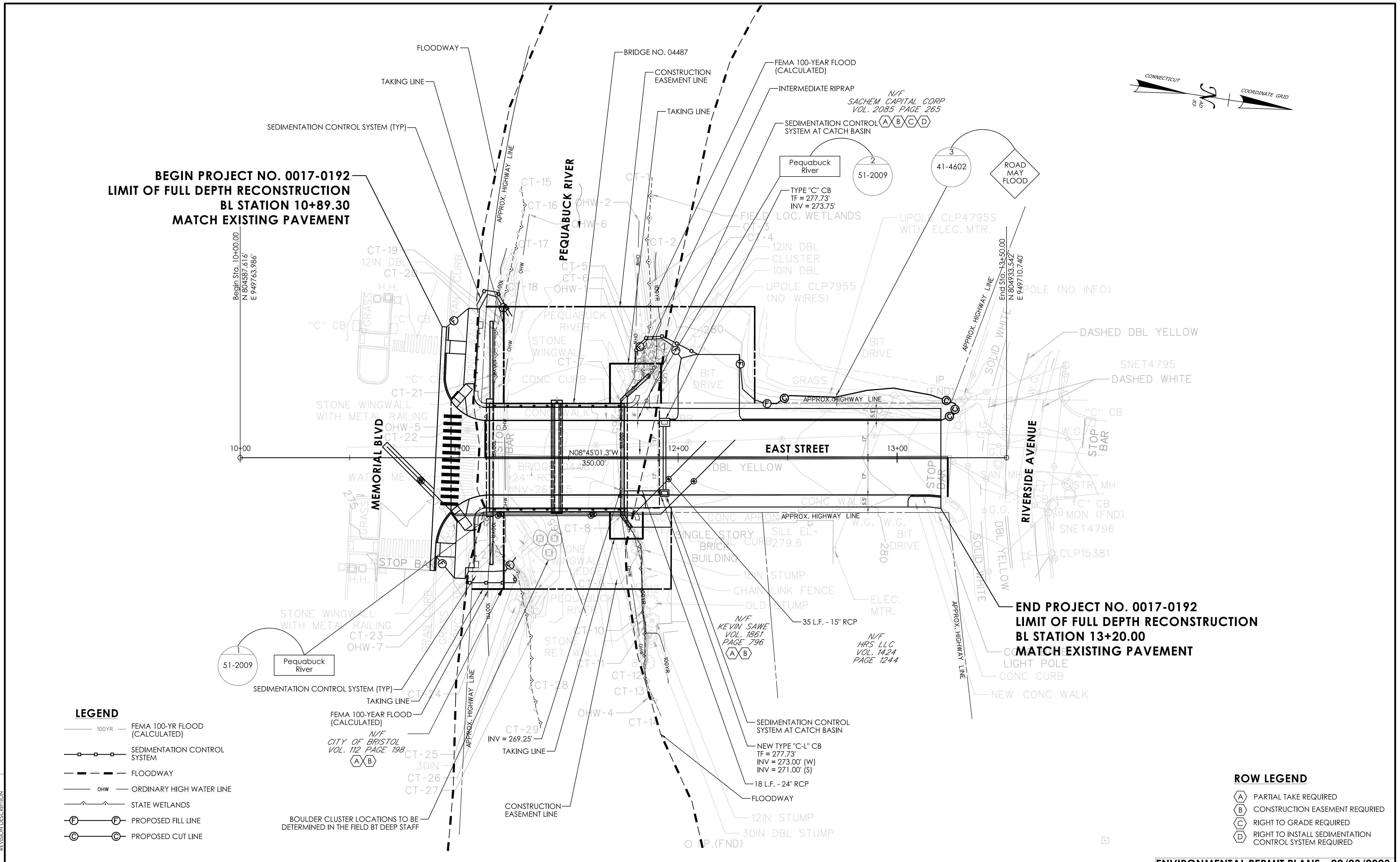

NOTES

1. ROUNDED BOULDERS APPROXIMATELY 2-3 FT. MIN. DIAMETER SHALL BE PLACED IN CLUSTERS, AS DIRECTED IN THE FIELD BY THE ENGINEER OR THEIR AUTHORIZED DELEGATE. SEE SPECIAL PROVISION "PLACEMENT OF CHANNEL BOULDER"
2. FOR MULTIPLE CLUSTERS, THE DISTANCE BETWEEN CLUSTERS WILL BE BASED ON FIELD CONDITIONS

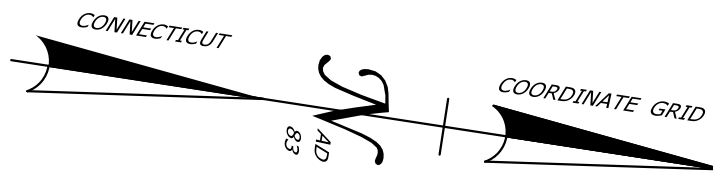

**BEGIN PROJECT NO. 0017-0192
LIMIT OF FULL DEPTH RECONSTRUCTION
BL STATION 10+89.30
MATCH EXISTING PAVEMENT**

Bruce H Williams
DEEP Fisheries Division - 03/23/23

- NOTE
1. AREAS OF TEMPORARY DISTURBANCE WITHIN WETLANDS SHALL BE RESTORED FOLLOWING CONSTRUCTION ACTIVITIES WITH WETLAND SEED MIX.
 2. THE CONTRACTOR SHALL NOT WORK WITHIN THE LIMITS OF THE WETLANDS AND WATERCOURSES WITH THE EXCEPTION OF THOSE AREAS DELINEATED AS TEMPORARY AND PERMANENT IMPACTS TO THE WETLANDS AND WATERCOURSE.
 3. ALL UNCONFINED INSTREAM WORK IS RESTRICTED TO THE PERIOD FROM JUNE 1st THROUGH SEPTEMBER 30th, INCLUSIVE.
 4. LOCATION OF THE BOULDER CLUSTERS TO BE DETERMINED IN THE FIELD BY DEEP FISHERIES STAFF.

LEGEND

- 100YR — FEMA 100-YR FLOOD (CALCULATED)
- [Symbol] — SEDIMENTATION CONTROL SYSTEM
- [Symbol] — FLOODWAY
- [Symbol] — OHW — ORDINARY HIGH WATER LINE
- [Symbol] — STATE WETLANDS
- [Symbol] — PROPOSED FILL LINE
- [Symbol] — PROPOSED CUT LINE
- PERMANENT WETLAND/ WATERCOURSE IMPACTS
- ▨ TEMPORARY WETLAND/ WATERCOURSE IMPACTS

WETLAND IMPACT TABLE			
	WETLAND IMPACTS	WATERCOURSE IMPACTS	TOTAL
PERMANENT	730 SF	746 SF	1476 SF
TEMPORARY	34 SF	1429 SF	1463 SF
TOTAL	764 SF	2175 SF	2939 SF

NOTE: THERE ARE NO FEDERAL WETLANDS WITHIN THE PROJECT LIMITS.

N/F
SACHEM CAPITAL CORP
VOL. 2085 PAGE 265

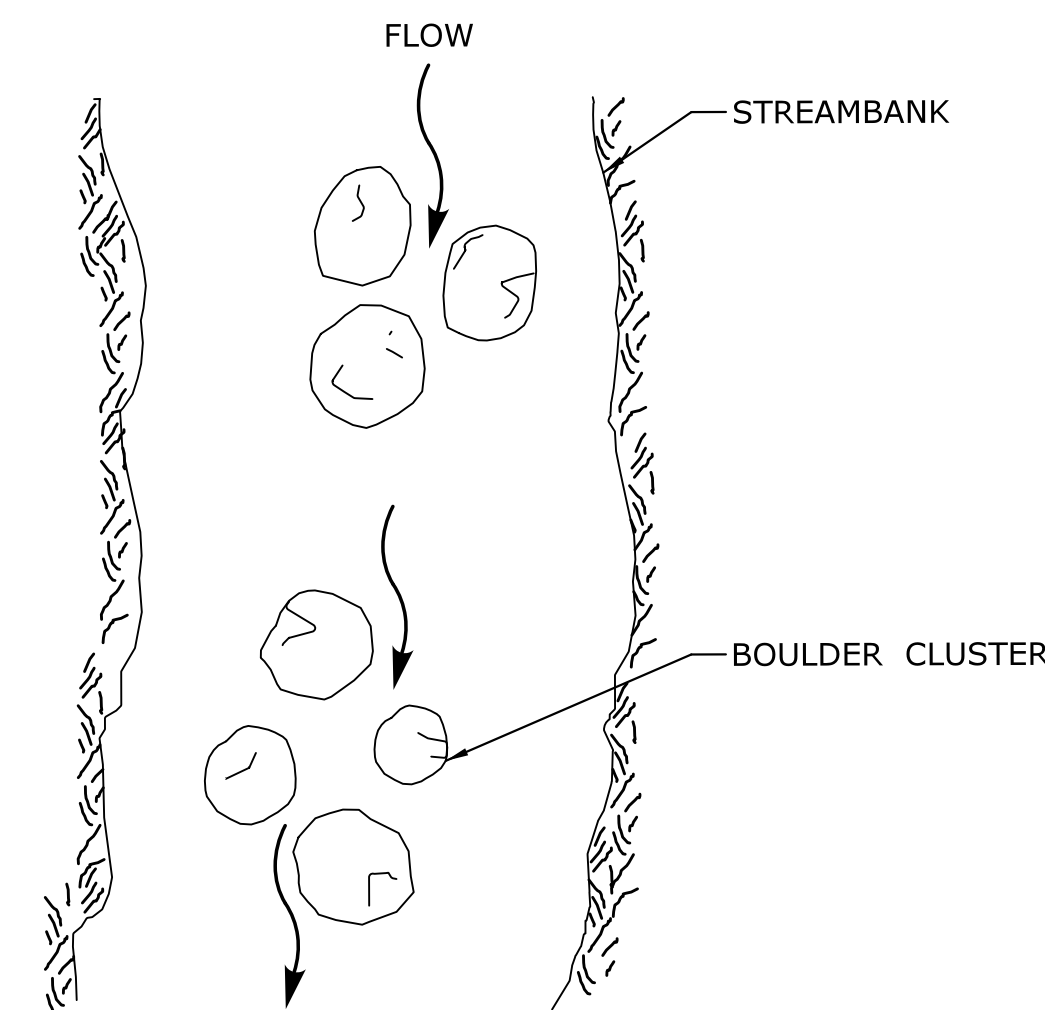

**PLACEMENT OF CHANNEL BOULDERS
PLAN VIEW**
N.T.S.

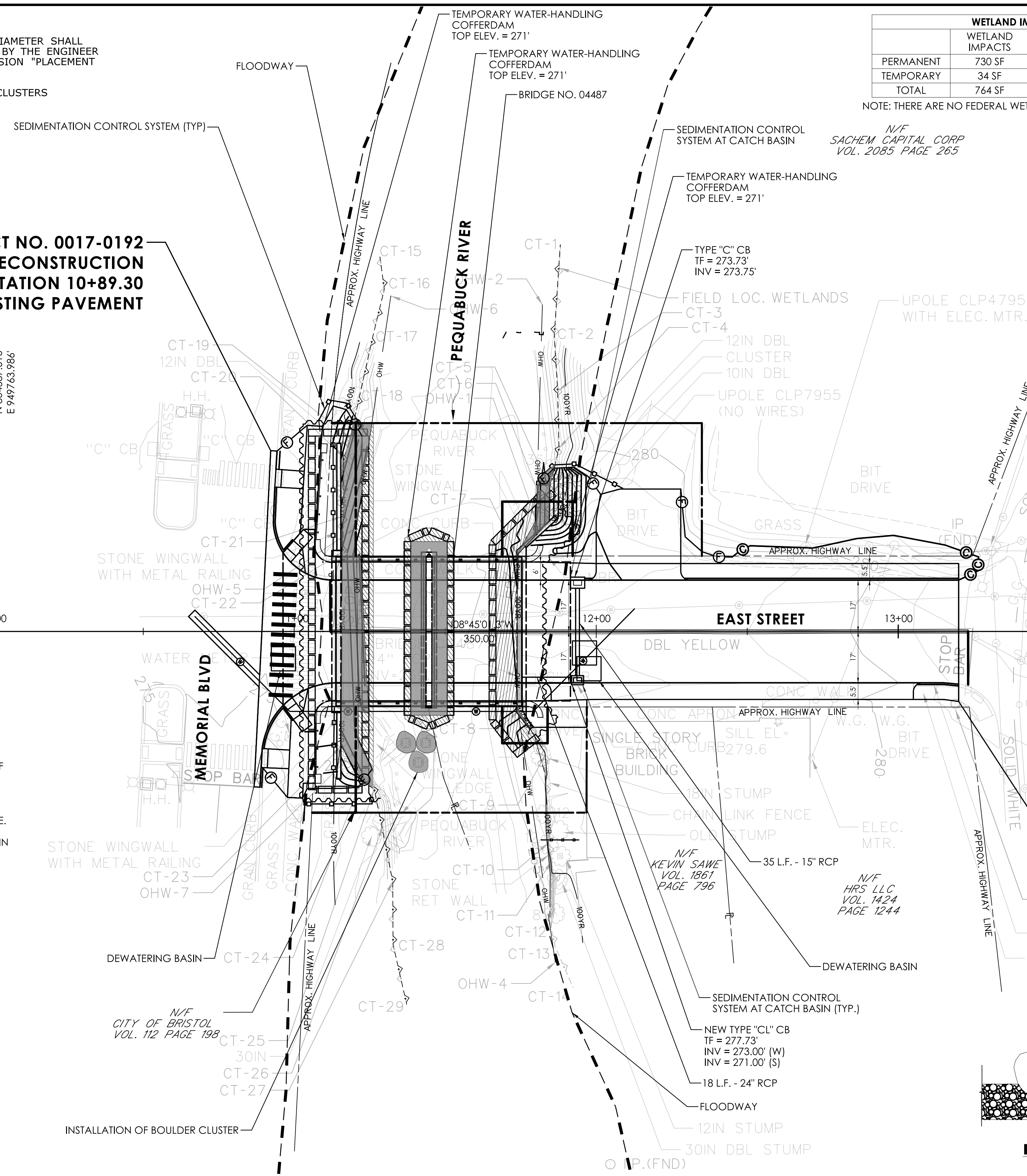

**END PROJECT NO. 0017-0192
LIMIT OF FULL DEPTH RECONSTRUCTION
BL STATION 13+20.00
MATCH EXISTING PAVEMENT**

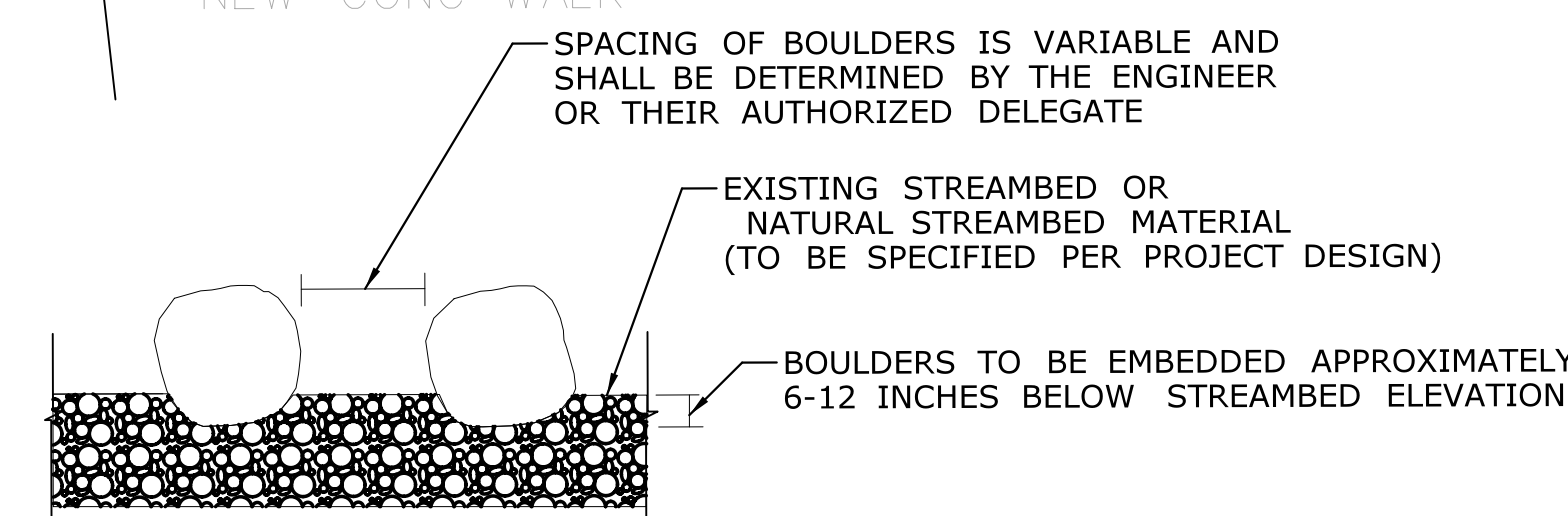

**PLACEMENT OF CHANNEL BOULDERS
SECTION VIEW**
N.T.S.

REV.	DATE	REVISION DESCRIPTION

FINAL DESIGN REVIEW

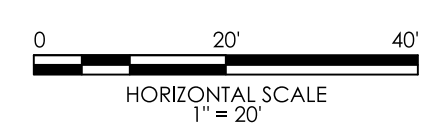

SIGNATURE/BLOCK:
GMP
GMP ASSOCIATES, INC.
115 GLASTONBURY BLVD.
GLASTONBURY, CT 06033



CITY OF BRISTOL

PROJECT NUMBER: 0017-0192
PROJECT DESCRIPTION: REPLACEMENT OF BRIDGE NO. 04487, EAST STREET OVER PEQUABUCK RIVER
TOWN(S): BRISTOL
DRAWING TITLE: WETLAND IMPACT PLAN

ENVIRONMENTAL PERMIT PLANS - 02/03/2023

DRAWING NO.
PMT-03
SHEET NO.

**BEGIN PROJECT NO. 0017-0192
LIMIT OF FULL DEPTH RECONSTRUCTION
BL STATION 10+89.30
MATCH EXISTING PAVEMENT**

**END PROJECT NO. 0017-0192
LIMIT OF FULL DEPTH RECONSTRUCTION
BL STATION 13+20.00
MATCH EXISTING PAVEMENT**

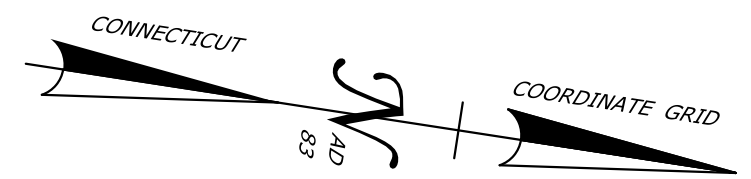

- LEGEND**
- 100YR FEMA 100-YR FLOOD (CALCULATED)
 - SEDIMENTATION CONTROL SYSTEM
 - FLOODWAY
 - OHW ORDINARY HIGH WATER LINE
 - STATE WETLANDS
 - PROPOSED FILL LINE
 - PROPOSED CUT LINE
 - FLOODWAY IMPACTS
 - 100-YEAR FLOODPLAIN IMPACTS

100-YEAR FLOODPLAIN AREA IMPACTS, CUT & FILL INFORMATION	
VOLUME IMPACTS	
EXCAVATION IN FEMA FLOODPLAIN	FILL IN FEMA FLOODPLAIN
152 CY	589 CY

NOTE
1. AREAS OF TEMPORARY DISTURBANCE WITHIN WETLANDS SHALL BE RESTORED FOLLOWING CONSTRUCTION ACTIVITIES WITH WETLAND SEED MIX.

ENVIRONMENTAL PERMIT PLANS - 02/03/2023

REV.	DATE	REVISION DESCRIPTION

FINAL DESIGN REVIEW
DESIGNER/DRAFTER: NAB CHECKED BY: PMB

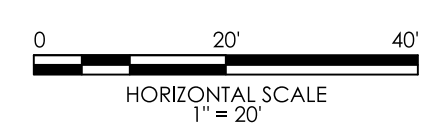

SIGNATURE/BLOCK: **GMP**
GMP ASSOCIATES, INC.
115 GLASTONBURY BLVD.
GLASTONBURY, CT 06033



CITY OF BRISTOL

PROJECT NUMBER: 0017-0192
PROJECT DESCRIPTION: REPLACEMENT OF BRIDGE NO. 04487, EAST STREET OVER PEQUABUCK RIVER
TOWN(S): BRISTOL
DRAWING TITLE: 100-YEAR FLOODPLAIN IMPACT PLAN

DRAWING NO. PMT-04
SHEET NO.

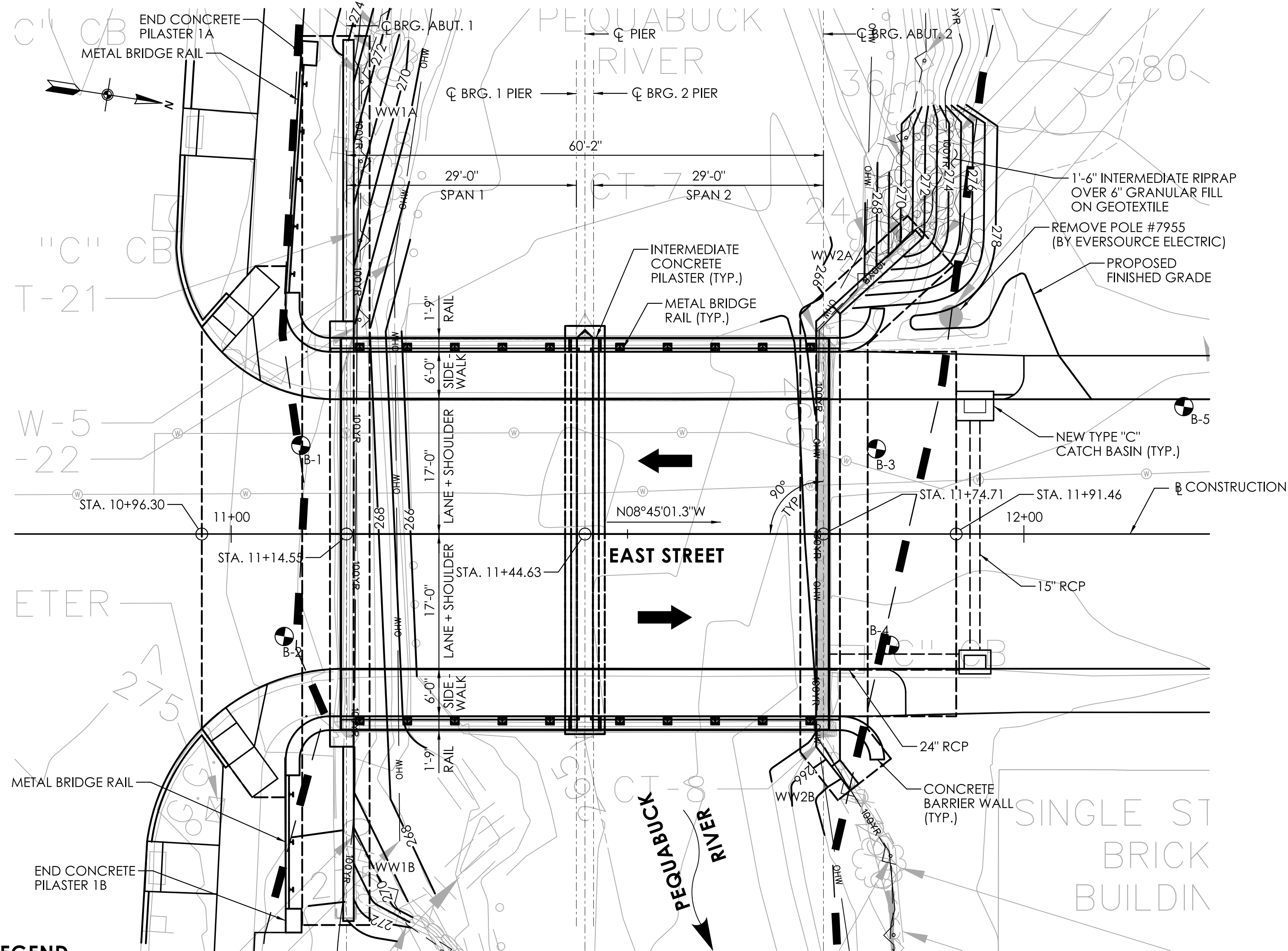

PLAN
SCALE: 1" = 10'

LEGEND

- STATE/FEDERAL WETLANDS
- FEMA 100-YEAR FLOOD (CALCULATED)
- FLOODWAY
- ORDINARY HIGH WATER
- SOIL BORING LOCATION

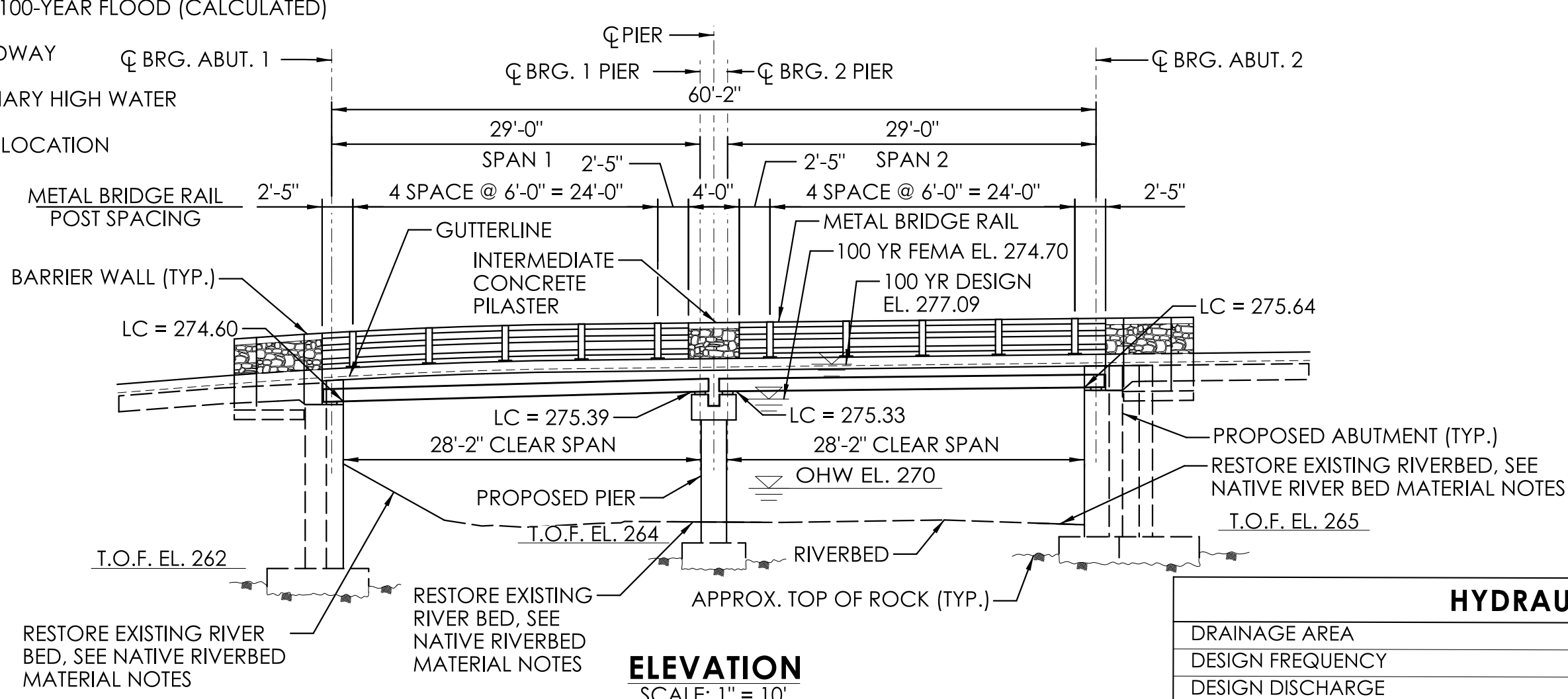

ELEVATION
SCALE: 1" = 10'

NATIVE RIVERBED MATERIAL NOTES:

1. NATIVE RIVERBED MATERIAL EXCAVATED DURING PROPOSED ABUTMENTS AND PIER INSTALLATION SHALL BE STOCKPILED AND THEN REPLACED WITHIN DISTURBED AREAS OF RIVERBED TO THE DEPTH SHOWN ON THE PLANS OR AS DIRECTED BY THE ENGINEER IN ACCORDANCE WITH THE SPECIAL PROVISION FOR THE ITEM "REUSE OF EXISTING CHANNEL BOTTOM MATERIAL".
2. ADDITIONAL RIVERBED MATERIAL, IF REQUIRED, SHALL BE IN ACCORDANCE WITH THE SPECIAL PROVISION FOR THE ITEM "REUSE OF EXISTING CHANNEL BOTTOM MATERIAL".
3. THE STOCKPILE SHALL BE LOCATED OUTSIDE THE WETLAND LIMITS AND PROTECTED WITH SEDIMENTATION CONTROL SYSTEM.

HYDRAULIC DATA

DRAINAGE AREA	24.60 SQ. MI.
DESIGN FREQUENCY	100 YEAR
DESIGN DISCHARGE	6260 CFS
AVERAGE DAILY FLOW ELEVATION	267.49 FT.
UPSTREAM DESIGN WATER SURFACE ELEVATION	277.09 FT.
DOWNSTREAM DESIGN WATER SURFACE ELEVATION	273.95 FT.
MAXIMUM SCOUR ELEVATION	262.49 FT.
FREQUENCY DISCHARGE	200 YEAR
DISCHARGE	7270 CFS
WORST CASE SCOUR SUBSTRUCTURE UNIT	SAME

GENERAL NOTES:

SPECIFICATIONS: CONNECTICUT DEPARTMENT OF TRANSPORTATION FORM 818 DATED 2020; SUPPLEMENTAL SPECIFICATION DATED JULY 2022 AND SPECIAL PROVISIONS.

DESIGN SPECIFICATIONS: AASHTO LRFD BRIDGE DESIGN SPECIFICATIONS (9TH EDITION - 2020), AS SUPPLEMENTED BY THE CONNECTICUT DEPARTMENT OF TRANSPORTATION BRIDGE DESIGN MANUAL (2003), WITH THE LATEST REVISIONS.

MATERIAL STRENGTHS:

CONCRETE:
 CLASS PCC 03340f'c=3,000 psi
 CLASS PCC 04460f'c=4,000 psi
 CLASS PCC 04462f'c=4,000 psi
 PRESTRESSED DECK UNITSf'c=8,000 psi

THE CONCRETE STRENGTH, f'c, USED IN DESIGN OF THE CONCRETE COMPONENTS IS NOTED ABOVE. THE COMPRESSIVE STRENGTH OF THE CONCRETE IN THE CONSTRUCTED COMPONENTS SHALL CONFORM TO THE REQUIREMENTS OF 6.01- CONCRETE FOR STRUCTURES AND M.03- PORTLAND CEMENT CONCRETE.

REINFORCEMENT: (ASTM A615 GRADE 60)..... fy = 60,000 PSI

LIVE LOAD: HL-93, LEGAL AND PERMIT VEHICLES.

FUTURE PAVING ALLOWANCE: NONE.

BITUMINOUS CONCRETE OVERLAY: THIS SHALL CONSIST OF TWO LIFTS: THE FIRST (BOTTOM LIFT) SHALL BE "HMA S0.25 TRAFFIC LEVEL 2" (1" THICK) AND THE SECOND (TOP LIFT) SHALL BE "HMA S0.5 TRAFFIC LEVEL 2" (2" THICK).

FOUNDATION PRESSURES: THE LIMIT STATES NOTED ON THE SUBSTRUCTURE PLAN SHEETS REFER TO LOAD COMBINATIONS AS GIVEN IN THE AASHTO LRFD BRIDGE DESIGN SPECIFICATIONS.

DIMENSIONS: WHEN DECIMAL DIMENSIONS ARE GIVEN LESS THAN THREE DECIMAL PLACES, THE OMITTED DIGITS SHALL BE ASSUMED TO BE ZEROS.

EXISTING DIMENSIONS: DIMENSIONS OF THE EXISTING STRUCTURE SHOWN ON THESE PLANS ARE FOR GENERAL REFERENCE ONLY. THEY HAVE BEEN TAKEN FROM THE LIMITED SURVEY AND ARE NOT GUARANTEED. THE CONTRACTOR SHALL TAKE ALL FIELD MEASUREMENTS NECESSARY TO ASSURE PROPER FIT OF THE FINISHED WORK AND SHALL ASSUME FULL RESPONSIBILITY FOR THEIR ACCURACY. WHEN SHOP DRAWINGS BASED ON FIELD MEASUREMENTS ARE SUBMITTED FOR REVIEW, THE FIELD MEASUREMENTS SHALL ALSO BE SUBMITTED FOR REFERENCE BY THE REVIEWER.

EXISTING BRIDGE: THE WORK FOR REMOVAL OF THE EXISTING SUPERSTRUCTURE SHALL BE INCLUDED AND PAID FOR UNDER THE ITEM "REMOVAL OF SUPERSTRUCTURE". THE WORK FOR REMOVAL OF EXISTING ABUTMENTS, PIER, AND WINGWALLS SHALL BE PAID FOR UNDER ITEM "REMOVAL OF EXISTING MASONRY".

UTILITIES: THE FOLLOWING UTILITIES ARE LOCATED WITHIN THE PROJECT LIMITS AND SHALL BE PROTECTED DURING CONSTRUCTION: 12 INCH WATER MAIN OWNED BY CITY OF BRISTOL WATER AND SEWER DEPARTMENT, AND ELECTRIC DISTRIBUTION UTILITY POLE OWNED BY EVERSOURCE ELECTRIC. THE CONTRACTOR SHALL COORDINATE ALL WORK RELATED TO UTILITY RELOCATION WITH THE RESPECTIVE UTILITY COMPANIES.

BRIDGE IDENTIFICATION PLACARDS: THE CONTRACTOR SHALL PROVIDE AND INSTALL NEW BRIDGE IDENTIFICATION SIGNS AT THE LEADING END OF EACH TIMBER END BLOCK ON THE TRAFFIC SIDE. THE SIGNS SHALL BE FABRICATED WITH 40 GAUGE ALUMINUM SHEET METAL. THE SIGNS SHALL BE 4" X 12" WITH 3" WHITE RETROREFLECTIVE BLOCK LETTERS ON GREEN RETROREFLECTIVE SHEETING. EACH SIGN SHALL READ 04487. ALL COSTS ASSOCIATED WITH PROVIDING AND INSTALLING THE BRIDGE SIGNS SHALL BE COVERED UNDER ITEM # 1208931- SIGN FACE SHEET ALUMINUM (TYPE IX RETROREFLECTIVE SHEETING). THE FINAL LOCATION AND ATTACHMENT METHOD FOR THE SIGNS SHALL BE APPROVED BY THE ENGINEER PRIOR TO ATTACHMENT.

CONCRETE NOTES:

FOR CONCRETE NOTES SEE NEXT SHEET.

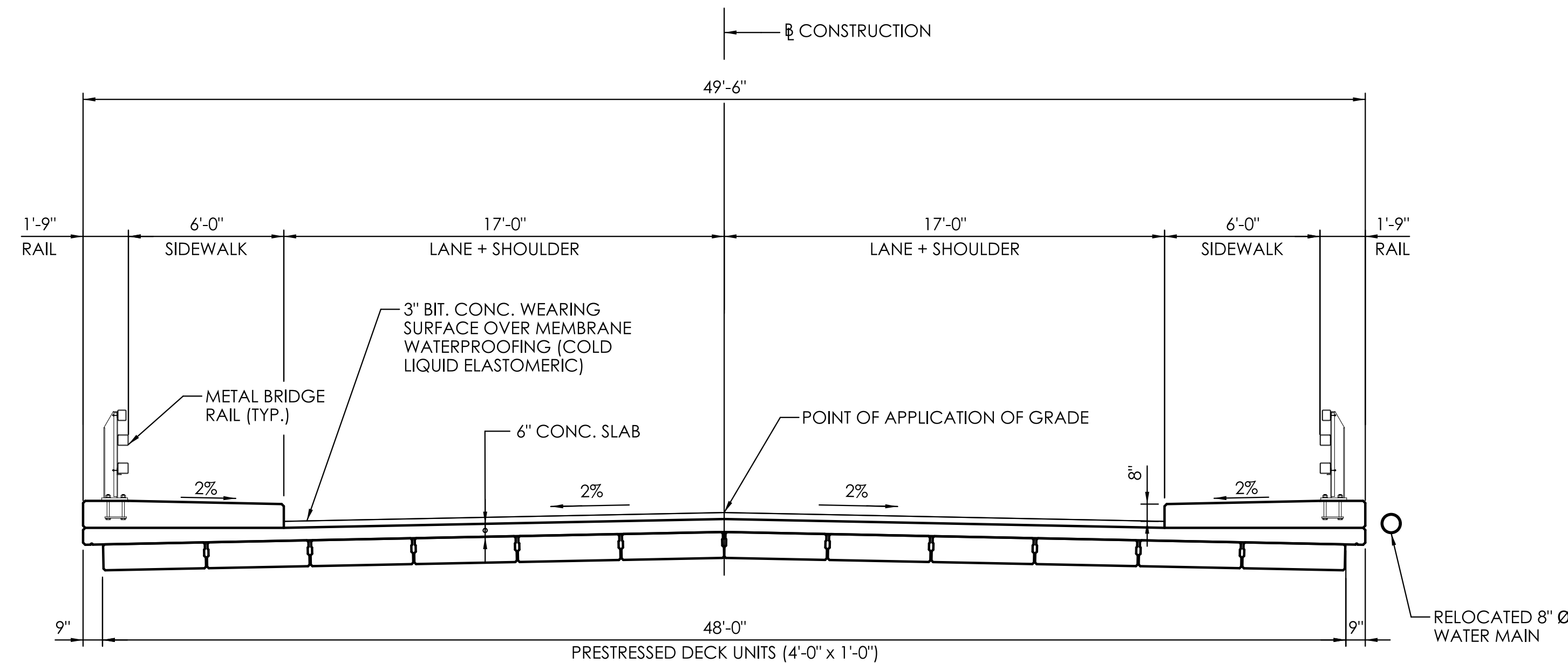

PROPOSED TYPICAL SECTION

SCALE: 1/4" = 1'-0"

INSPECTION OF FIELD WELDS

METHOD	UNIT	QUANTITY
ULTRASONIC	IN	0
MAGNETIC PARTICLE	IN	0

CONCRETE DISTRIBUTION

SUBSTRUCTURE	C.Y.	105
SUBSTRUCTURE	C.Y.	408
FOOTINGS	C.Y.	153
TOTAL	C.Y.	666

NOTICE TO BRIDGE INSPECTORS

THE DEPARTMENT'S BRIDGE SAFETY PROCEDURES REQUIRE THIS BRIDGE TO BE INSPECTED FOR, BUT NOT LIMITED TO, ALL APPROPRIATE COMPONENTS INDICATED IN THE GOVERNING MANUAL FOR BRIDGE INSPECTION. ATTENTION MUST BE GIVEN TO INSPECTING THE FOLLOWING SPECIAL COMPONENTS AND DETAILS. THE LISTING FOR SPECIFIC ATTENTION SHALL NOT BE CONSTRUED TO REDUCE THE IMPORTANCE OF INSPECTION OF ANY OTHER COMPONENT OF THE STRUCTURE. THE FREQUENCY OF INSPECTION OF THIS STRUCTURE SHALL BE IN ACCORDANCE WITH THE GOVERNING MANUALS FOR BRIDGE INSPECTION, UNLESS OTHERWISE DIRECTED BY THE MANAGER OF SAFETY AND EVALUATION.

COMPONENT OR DETAIL	STRUCTURE SHEET REFERENCE
FOLLOW NORMAL INSPECTION PROCEDURES	

ENVIRONMENTAL PERMIT PLANS - 02/03/2023

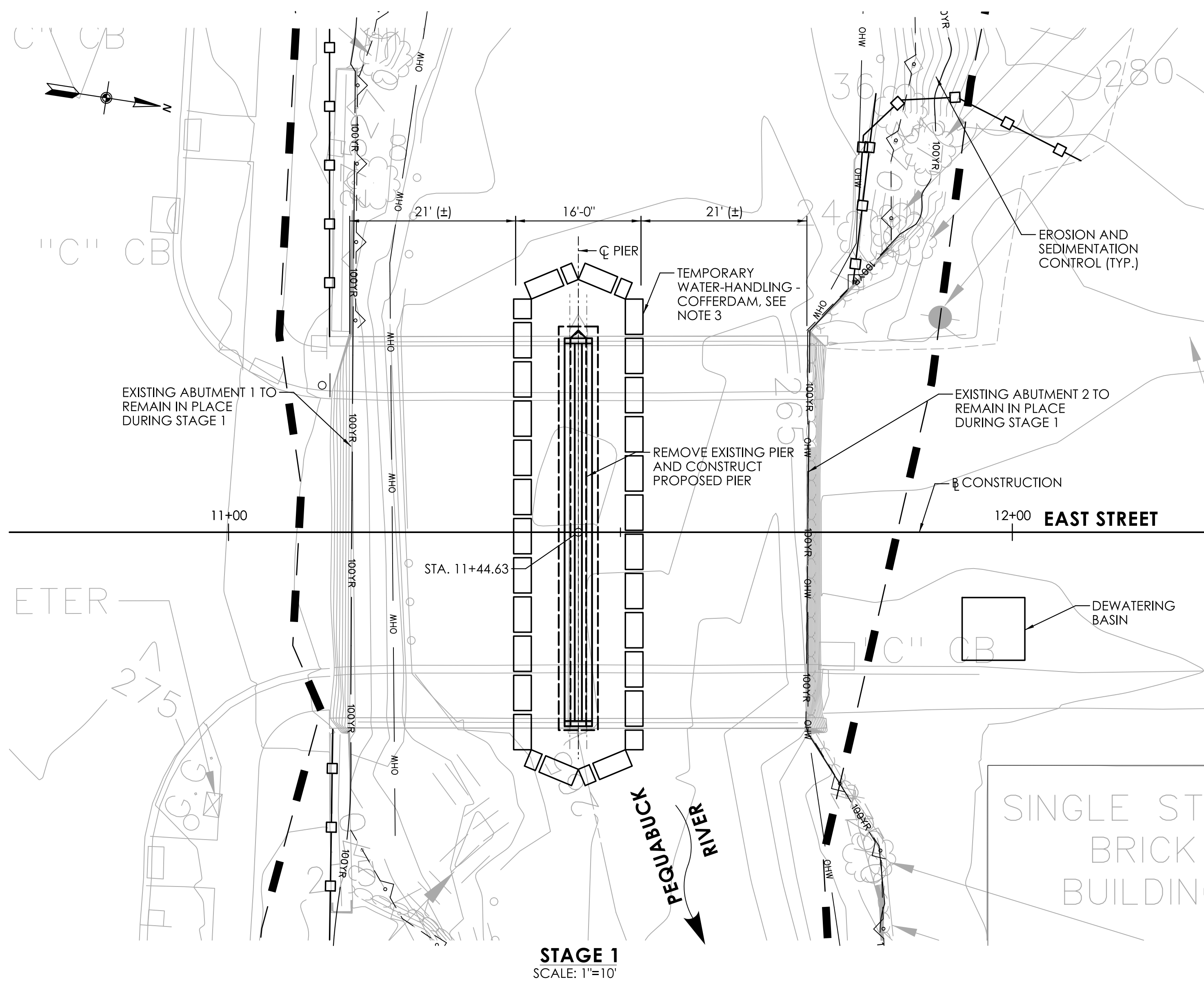

STAGE 1
SCALE: 1"=10'

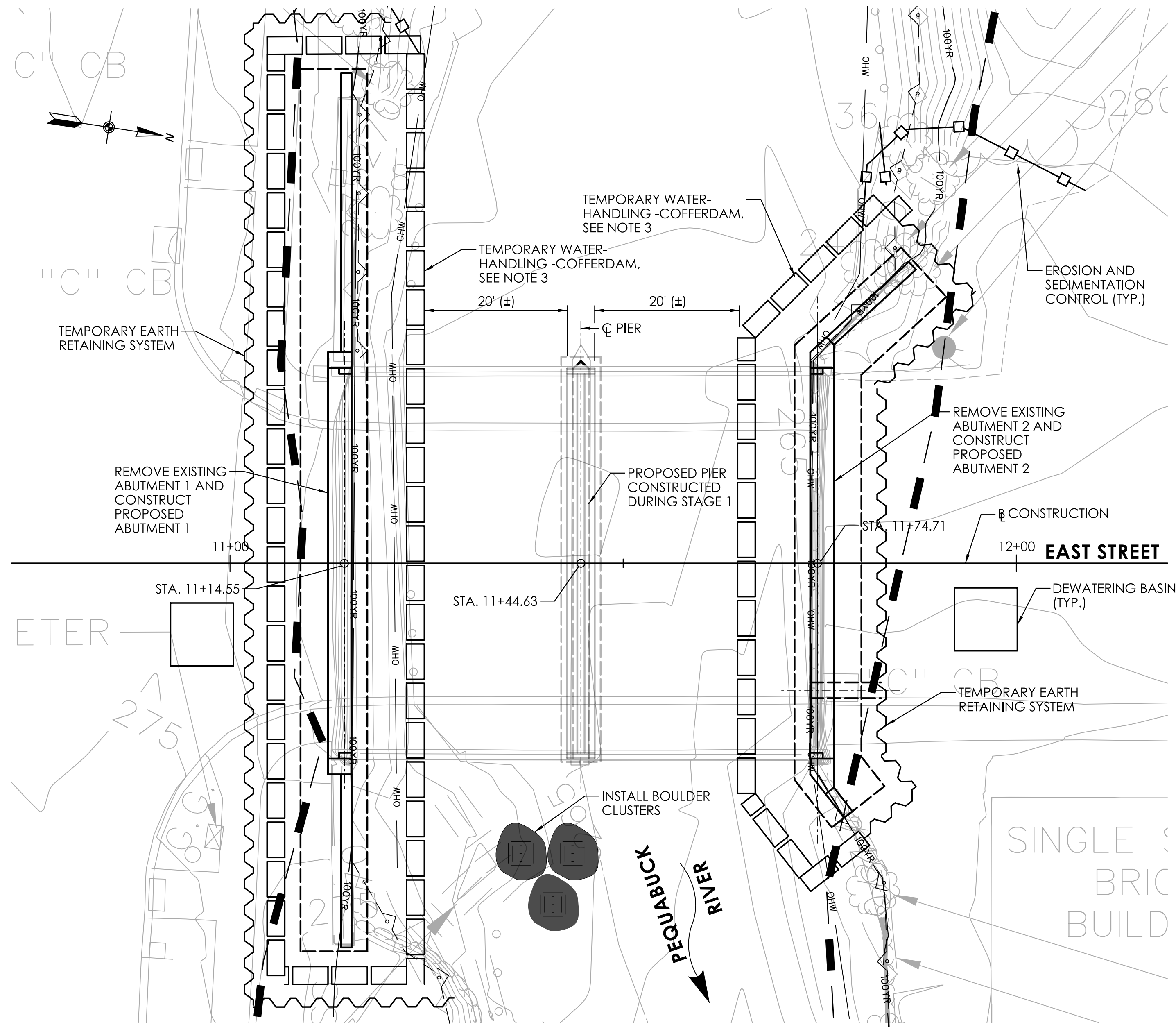

STAGE 2
SCALE: 1"=10'

SUGGESTED SEQUENCE OF CONSTRUCTION

THE FOLLOWING IS THE SUGGESTED SEQUENCE OF CONSTRUCTION THAT MAY BE FOLLOWED. THE CONTRACTOR SHALL SUBMIT HIS SEQUENCE OF CONSTRUCTION TO THE ENGINEER FOR APPROVAL.

PRE-STAGE 1

1. INSTALL DETOUR SIGNS AND PLACE TEMPORARY PRECAST CONCRETE BARRIER CURB, CLOSING EAST STREET TO THROUGH TRAFFIC. PRIOR TO ANY ROAD CLOSURE, THE CONTRACTOR SHALL COORDINATE WITH THE CITY OF BRISTOL. SEE SPECIAL PROVISIONS FOR THE ITEM "MAINTENANCE AND PROTECTION OF TRAFFIC" AND THE DETOUR PLAN FOR ADDITIONAL REQUIREMENTS.
2. CUT OFF AND CAP EXISTING WATER MAIN FOR THE DURATION OF CONSTRUCTION.
3. INSTALL NECESSARY EROSION AND SEDIMENTATION CONTROLS.
4. INSTALL DEBRIS SHIELD ABOVE EL. 272 AND REMOVE EXISTING SUPERSTRUCTURE.
5. REMOVE DEBRIS SHIELD.

STAGE 1

1. INSTALL TEMPORARY WATER HANDLING COFFERDAMS FOR STAGE 1 TO THE LIMITS SHOWN ON THIS PLAN. SEE WATER HANDLING NOTES FOR ADDITIONAL INFORMATION.
2. REMOVE THE EXISTING PIER IN ITS ENTIRETY.
3. CONSTRUCT PROPOSED PIER FOOTING, STEM AND PIER CAP.
4. REMOVE TEMPORARY WATER HANDLING COFFERDAMS FOR STAGE 1.

STAGE 2

1. INSTALL TEMPORARY WATER HANDLING COFFERDAMS FOR STAGE 2 TO THE LIMITS SHOWN ON THIS PLAN. SEE WATER HANDLING NOTES FOR ADDITIONAL INFORMATION.
2. REMOVE THE EXISTING ABUTMENTS AND WINGWALLS IN THEIR ENTIRETY.
3. CONSTRUCT PROPOSED ABUTMENTS AND WINGWALLS FOOTINGS, AND STEMS.
4. BACKFILL PROPOSED BRIDGE AND REMOVE TEMPORARY WATER HANDLING COFFERDAMS FOR STAGE 2.
5. INSTALL BOULDER CLUSTERS.

POST-STAGE 2

1. INSTALL PRESTRESSED CONCRETE DECK UNITS.
2. POUR CONCRETE DECK.
3. CONSTRUCT APPROACH SLABS, SIDEWALKS, PILASTERS AND BARRIER WALLS. INSTALL METAL BRIDGE RAILS.
4. APPLY MEMBRANE WATERPROOFING AND FIRST LIFT OF BITUMINOUS OVERLAY.
5. CONSTRUCT ROADWAY APPROACHES TO THE BRIDGE.
6. APPLY FINAL LIFT OF THE BITUMINOUS OVERLAY TO THE ENTIRE PROJECT.
7. SAW AND SEAL OVERLAY AT THE ENDS OF THE BRIDGE DECK.
8. OPEN ROAD TO TRAFFIC AND PEDESTRIANS AND COMPLETE MISCELLANEOUS WORK.
9. INSTALL PROPOSED WATERMAIN.
10. REMOVE EROSION AND SEDIMENTATION CONTROLS UPON PERMANENT STABILIZATION.

TEMPORARY HYDRAULIC DATA	
AVERAGE DAILY FLOW	43.1 CFS
AVERAGE SPRING FLOW	85.7 CFS
TEMPORARY DESIGN DISCHARGE	984 CFS
TEMPORARY DESIGN FREQUENCY	2 YEAR
STAGE 1	
TEMPORARY WATER SURFACE ELEVATION UPSTREAM	270.44 FT
TEMPORARY WATER SURFACE ELEVATION DOWNSTREAM	267.94 FT
STAGE 2	
TEMPORARY WATER SURFACE ELEVATION UPSTREAM	270.45 FT
TEMPORARY WATER SURFACE ELEVATION DOWNSTREAM	267.74 FT

WATER HANDLING NOTES

1. THE SUGGESTED METHOD OF CONTROLLING WATER DURING CONSTRUCTION CONSISTS OF A TEMPORARY WATER-HANDLING-COFFERDAMS AS SHOWN ON THIS DRAWING AND SHALL BE PAID FOR UNDER THE ITEM "COFFERDAM AND DEWATERING".
2. THIS SUGGESTED WATER HANDLING SCHEME IS FOR THE CONSTRUCTION OF PROPOSED ABUTMENTS, PIER, AND WINGWALLS. THE INSTALLATION OF TEMPORARY WATER-HANDLING-COFFERDAM TO HANDLE WATER FOR ANY OTHER CONSTRUCTION ACTIVITIES IS NOT PERMITTED.
3. TOP OF THE TEMPORARY WATER-HANDLING-COFFERDAM SHALL BE EL. 271.00 (MIN.).
4. THE CONTRACTOR SHALL SUBMIT TO THE ENGINEER FOR REVIEW AND APPROVAL HIS PROPOSED PLAN FOR WATER HANDLING, INCLUDING METHODS NECESSARY FOR THE CONSTRUCTION OF SUBSTRUCTURE TO BE COMPLETED IN REASONABLY DRY CONDITIONS. REFER TO THE SPECIAL PROVISION FOR THE ITEM "COFFERDAM AND DEWATERING".
5. IN ADDITION TO THE PROPOSED METHODS OF HANDLING WATER, THE CONTRACTOR SHALL SUBMIT TO THE ENGINEER HIS PROPOSED METHODS OF REMOVING THE EXISTING SUPERSTRUCTURE AND EXISTING SUBSTRUCTURES. EXISTING SUPERSTRUCTURE REMOVAL SHALL BE PAID FOR UNDER THE ITEM "REMOVAL OF SUPERSTRUCTURE". REMOVAL OF EXISTING SUBSTRUCTURES SHALL BE PAID FOR UNDER THE ITEM "REMOVAL OF EXISTING MASONRY". SEE SPECIAL PROVISIONS.
6. NO WORK SHALL BEGIN UNTIL ALL APPROVALS HAVE BEEN OBTAINED FROM THE ENGINEER.

TIME-OF-YEAR RESTRICTION

ALL UNCONFIRMED INSTREAMWORK IS RESTRICTED TO THE PERIOD FROM JUNE 1ST THROUGH SEPTEMBER 30TH, INCLUSIVE.

LEGEND

- SEDIMENTATION CONTROL SYSTEM
- - - STATE WETLANDS
- FEMA 100-YEAR FLOOD (CALCULATED)
- - - FLOODWAY
- ORDINARY HIGH WATER

Bruce H Williams
DEEP Fisheries Division - 03/23/23

ENVIRONMENTAL PERMIT PLANS - 02/03/2023

REV.	DATE	REVISION DESCRIPTION

SIGNATURE/BLOCK: **GMP**
 GW2 ASSOCIATES, INC.
 115 GLASTONBURY BLVD.
 GLASTONBURY, CT 06033



CITY OF BRISTOL

PROJECT NUMBER: 0017-0192
 PROJECT DESCRIPTION: REPLACEMENT OF BRIDGE NO. 04487, EAST STREET OVER PEQUABUCK RIVER
 TOWN(S): BRISTOL
 DRAWING TITLE: WATER HANDLING PLAN

DRAWING NO. PMT-06
 SHEET NO.