

NOTES

1. PLANTINGS ON THIS SHEET ARE FOR ENVIRONMENTAL PERMITTING. ANY SUBSTITUTIONS TO THE PERMIT PLANTINGS SHALL BE COORDINATED WITH THE DEPARTMENT'S OFFICE OF ENVIRONMENTAL PLANNING (OEP).
2. PROPOSED PLANTINGS TO BE FIELD LOCATED BY CTDOT OEP OR THEIR DESIGNATED REPRESENTATIVE.
3. WOOD CHIP MULCH SHALL NOT BE PLACED IN THE WETLAND AREA.
4. DISTURBED AREAS BELOW THE WETLAND LIMIT SHALL BE SEEDED WITH WETLAND GRASS ESTABLISHMENT. DISTURBED AREAS ABOVE THE WETLAND LIMIT SHALL BE SEEDED WITH CONSERVATION SEEDING FOR SLOPES, OR OTHER SEED MIX AS SPECIFIED. ALL AREAS SHALL BE RESTORED.
5. ALL PLANT MATERIAL SHALL BE NURSERY GRADE STRAIGHT SPECIES, CONFORMING TO SECTION 3 OF THE AMERICAN STANDARDS FOR NURSERY STOCK. CTDOT OEP WILL REVIEW AND APPROVE PROPOSED PLANTINGS.
6. NO PLANTINGS SHALL BE PLACED IN MOW AREA.
7. AREA TO BE TREATED FOR INVASIVES SHALL BE PROPERLY PREPARED FOR FINAL PLANTING, SEEDING, AND RESTORATION.

PERMIT PLANT LIST

BOTANICAL NAME	COMMON NAME	SIZE	QTY.	SPACING	WETLAND INDICATOR
QUERCUS PALUSTRIS	PIN OAK	1 3/4"-2" CAL. B.B.	5	FIELD LOCATED	UPL
ASCLEPIAS TUBEROSA	BUTTERFLY WEED	1 GALLON CONTAINER	15	GROUPS OF 3	FACU
AMELANCHIER CANADENSIS	SERVICE-BERRY	4'-5' HT. B.B.	15	FIELD LOCATED	FAC
ILEX VERTICILLATA	COMMON WINTERBERRY	3'-4' HT. B.B.	15	FIELD LOCATED	FAC
CORNUS RACEMOSA	GRAY DOGWOOD	2'-3' HT. B.B.	15	FIELD LOCATED	FAC
CORNUS ALBA*	RED OSIER	24"-36" HT. B.B.	15	FIELD LOCATED	FACW
ALNUS INCANA	SPECKLED ALDER	4'-5' HT. B.B.	10	FIELD LOCATED	FACW
TOTAL			90		

*RED OSIER IS LISTED AS CORNUS ALBA, IN ACCORDANCE WITH THE USACE 2022 WETLAND PLANT LIST. FOR CONSTRUCTION PURPOSES, PAYMENT FOR RED OSIER SHALL BE PAID FOR UNDER ITEM NO. 0949023 - CORNUS SERICEA, RED OSIER DOGWOOD 24" - 36" HT. CONT.

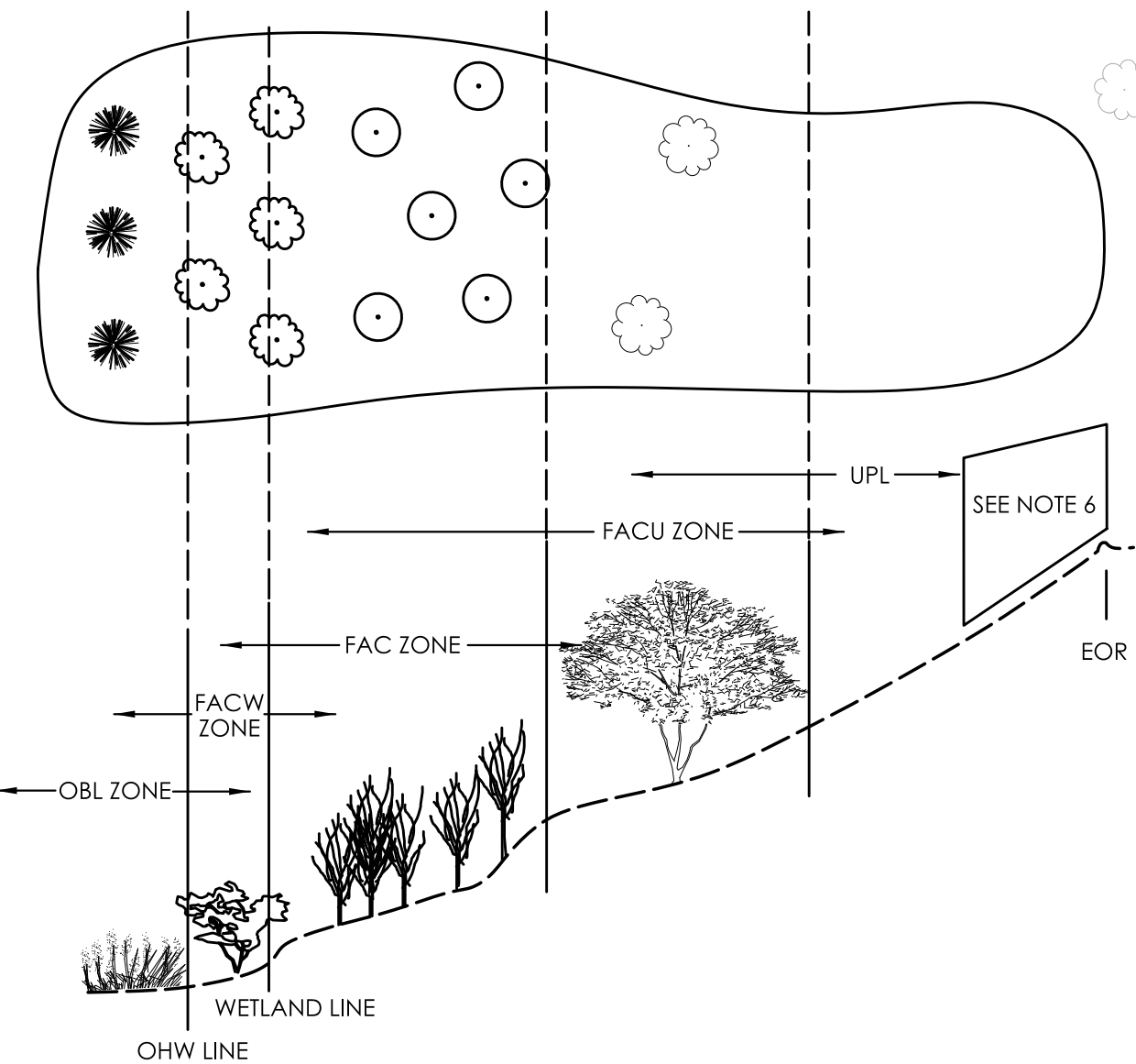
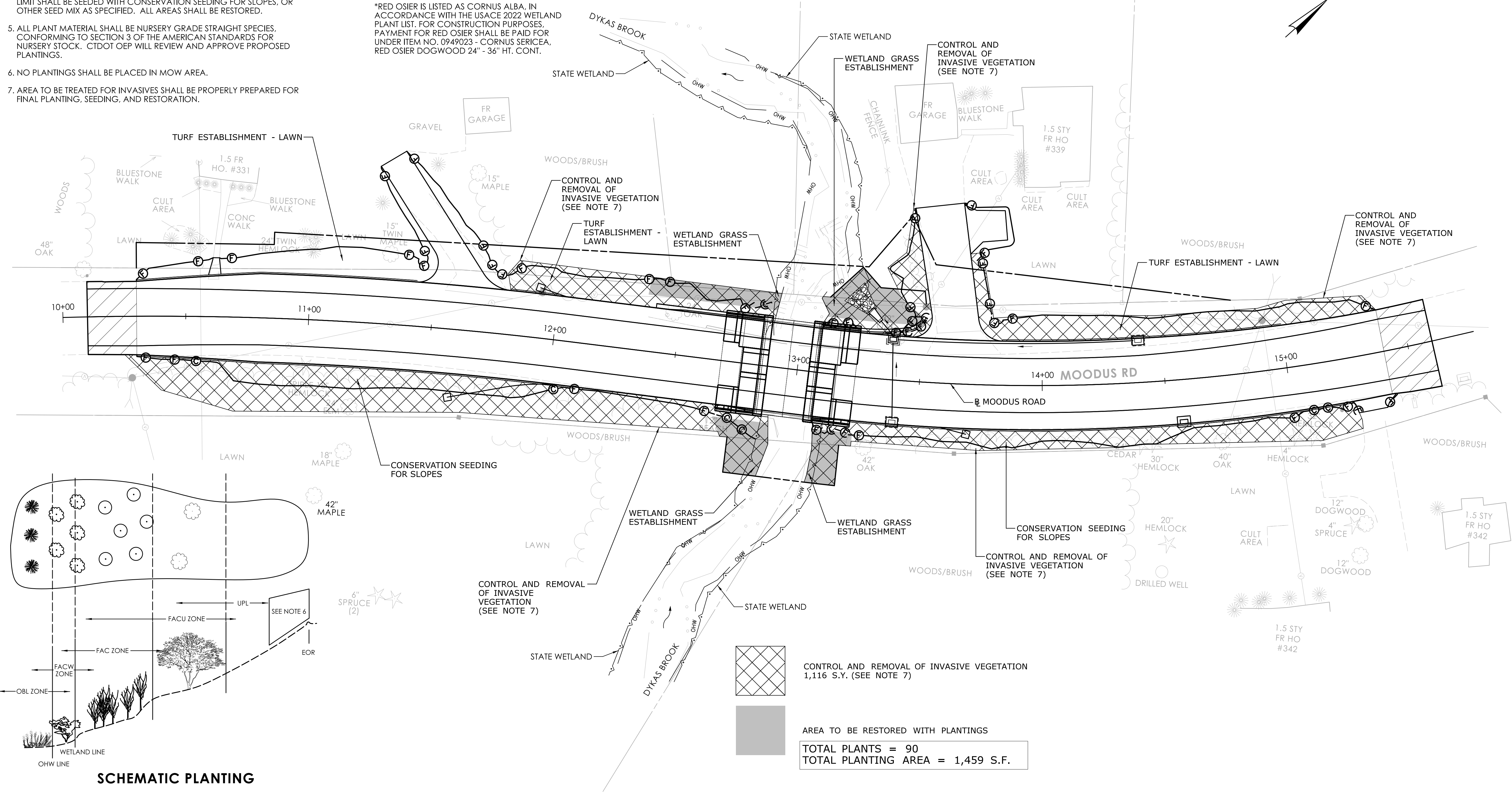

SCHEMATIC PLANTING

CONTROL AND REMOVAL OF INVASIVE VEGETATION
1,116 S.Y. (SEE NOTE 7)

AREA TO BE RESTORED WITH PLANTINGS

TOTAL PLANTS = 90
TOTAL PLANTING AREA = 1,459 S.F.

REV.	DATE	REVISION DESCRIPTION

SIGNATURE BLOCK:

100 GREAT MEADOW ROAD
WETHERFIELD, CT 06109

DESIGNER/DRAFTER: M. STOY CHECKED BY: S. NALITZ

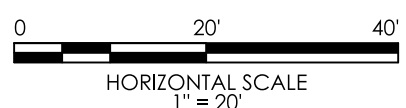

CONNECTICUT
DEPARTMENT OF
TRANSPORTATION

PROJECT TITLE:
REPLACEMENT OF BRIDGE NO. 02698 CARRYING ROUTE 149 (EAST HADDAM MOODUS ROAD) OVER DYKAS BROOK

TOWN(S):
EAST HADDAM

DRAWING TITLE:
PERMIT PLANTING PLAN

PROJECT NO.:
0040-0148

DRAWING NO.:
PMT-02
SHEET NO.:
06.02